

PROCESSTEC

GET TOMORROW'S TECHNOLOGY TODAY

CUSTOMER CATALOG RECOMMENDED SPARE PARTS

ViscoTwin 130-G7

MAINTENANCE LEVEL 2

RELEASE - NOVEMBER 2021
(valid until further notice)

| | |
|--|----------|
| RELEASE - NOVEMBER 2021..... | i |
| (valid until further notice) | i |
| 1. OVERVIEW ML2 G7 | 1 |
| 2. EXPLOSION DRAWINGS ML2: VT130-G7..... | 2 |
| 2.1. ML2 EXPLOSION DRAWING: 130-G7 SAMS ANGA | 2 |
| 2.2. ML2 EXPLOSION DRAWING: 130-G7 DAMS ANGA | 3 |
| 2.3. ML2 EXPLOSION DRAWING: 130-G7 SAMS HUHNSEAL | 4 |
| 2.4. ML2 EXPLOSION DRAWING: 130-G7 DAMS HUHNSEAL..... | 5 |
| 3. TORQUE VALUES ML2: V130-G7 | 6 |
| 4. SPARE PARTS ML2: VT130-G7 | 7 |
| 4.1 Pump Housing | 7 |
| 4.2 Seal Housing..... | 11 |
| 4.3 Bearing Housing..... | 16 |
| 4.4 Gear Housing | 18 |
| 4.5 Drive Train | 20 |

1. OVERVIEW ML2 G7

MOUNTING OPTIONS:

- Industrial with Frame (VT104, VT130 G7)
- Block with Lantern Feet, C-face (VT70 G7)

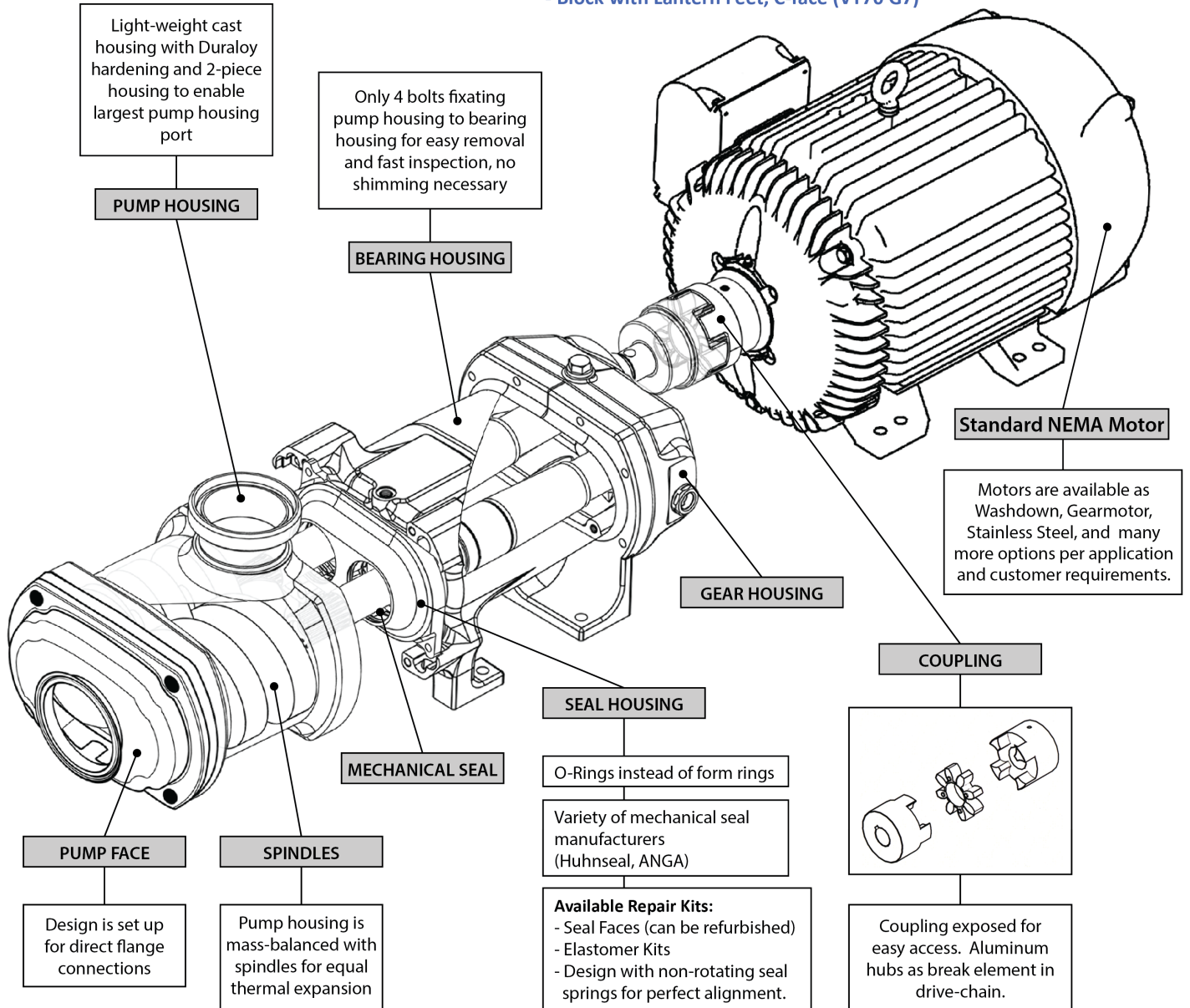

2. EXPLOSION DRAWINGS ML2: VT130-G7

2.1. ML2 EXPLOSION DRAWING: 130-G7 SAMS ANGA

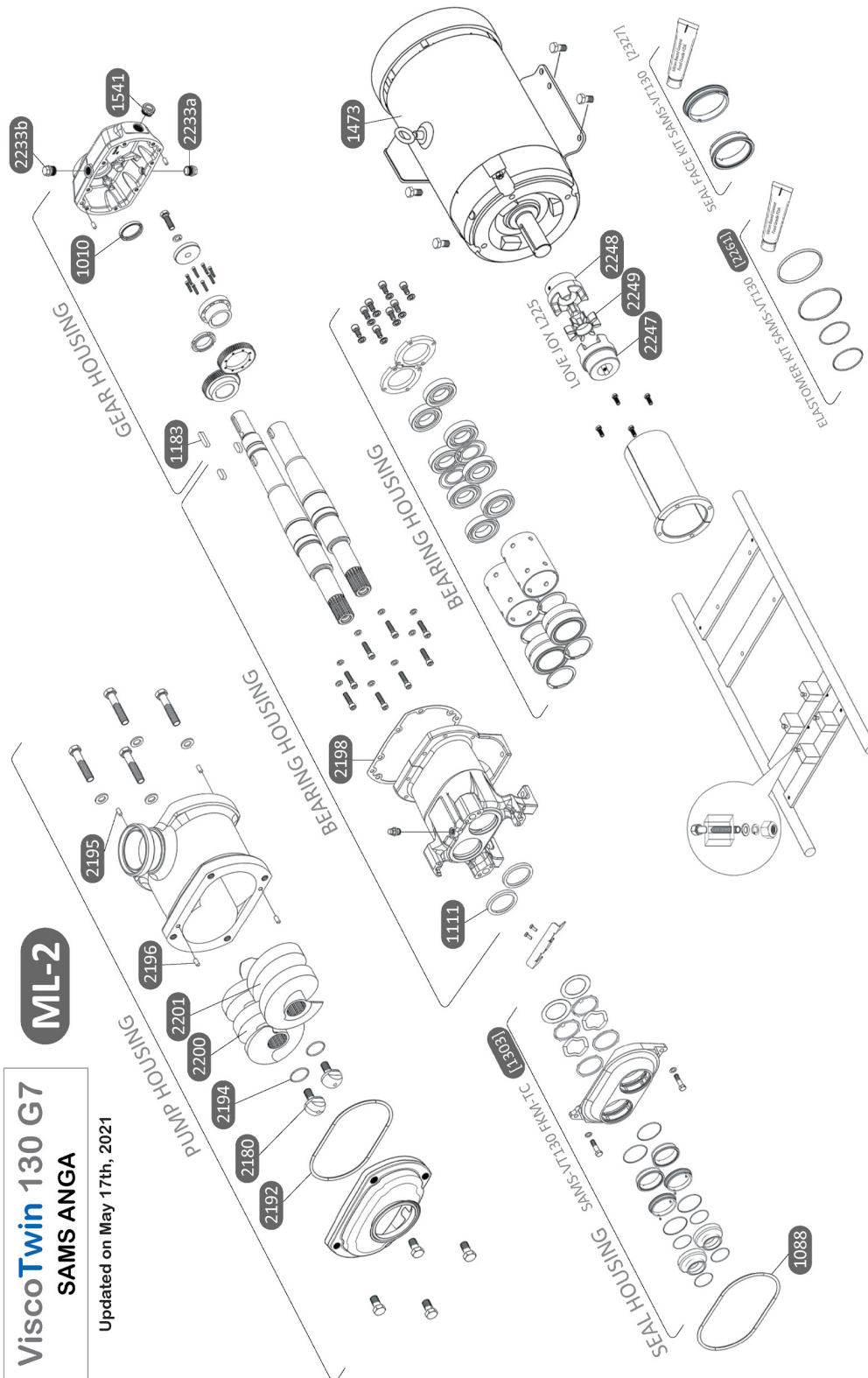

ML-2

**ViscoTwin 130 G7
SAMS ANGA**

Updated on May 17th, 2021



2.3. ML2 EXPLOSION DRAWING: 130-G7 SAMS HUHNSEAL

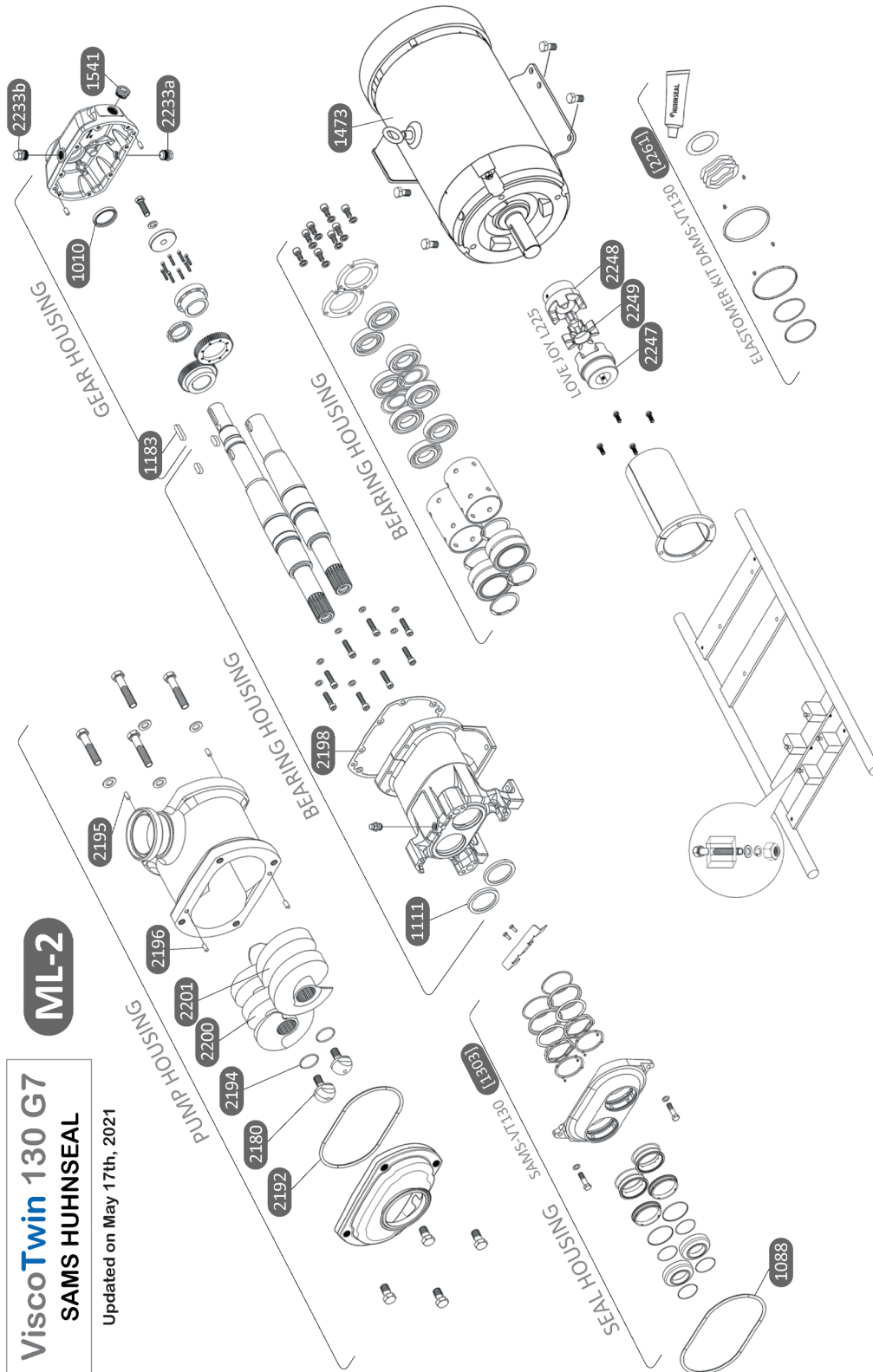

2.4. ML2 EXPLOSION DRAWING: 130-G7 DAMS HUHNSEAL

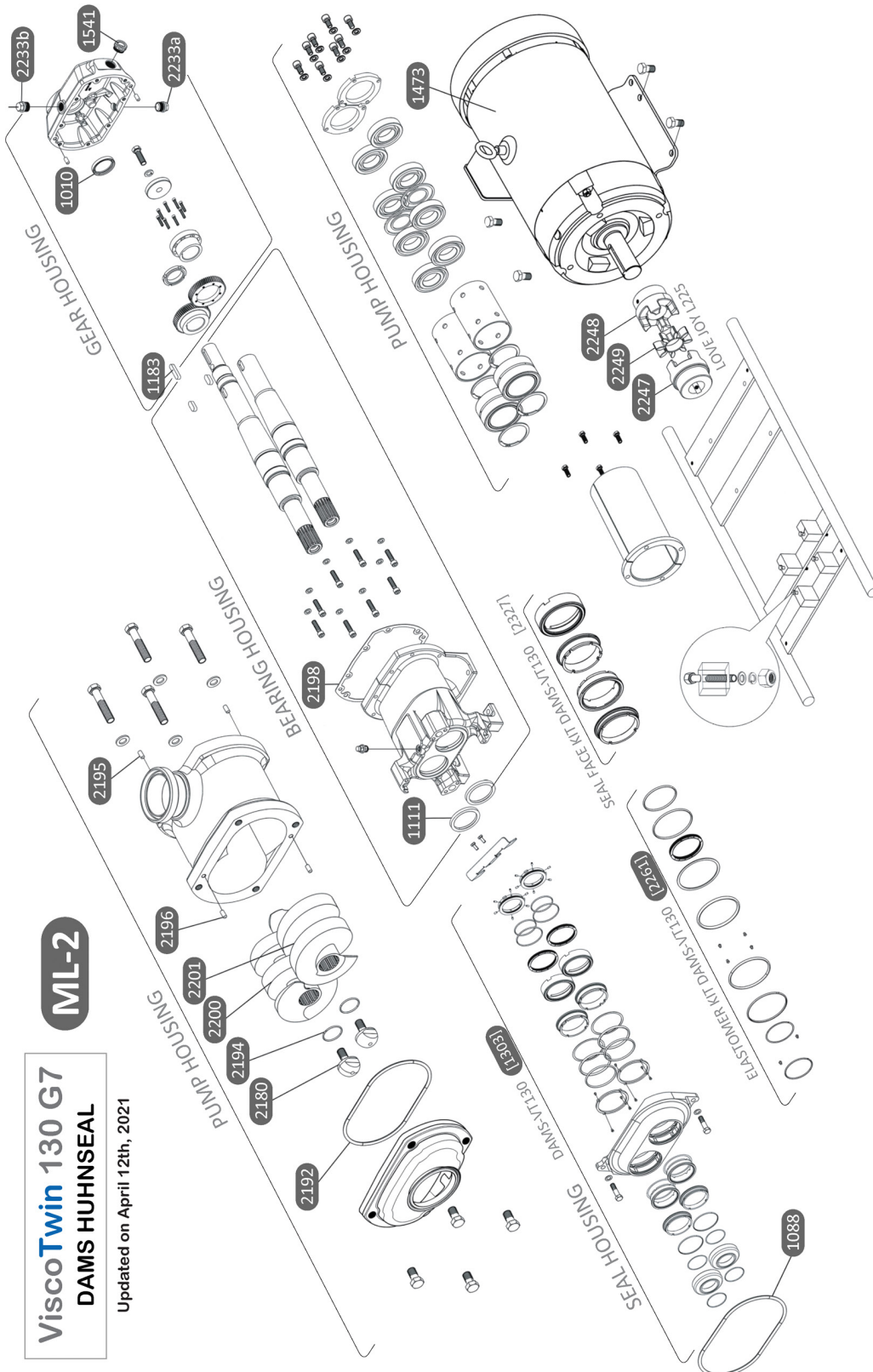

ML-2
ViscoTwin 130 G7
DAMS HUHNSEAL

Updated on April 12th, 2021



3. TORQUE VALUES ML2: V130-G7

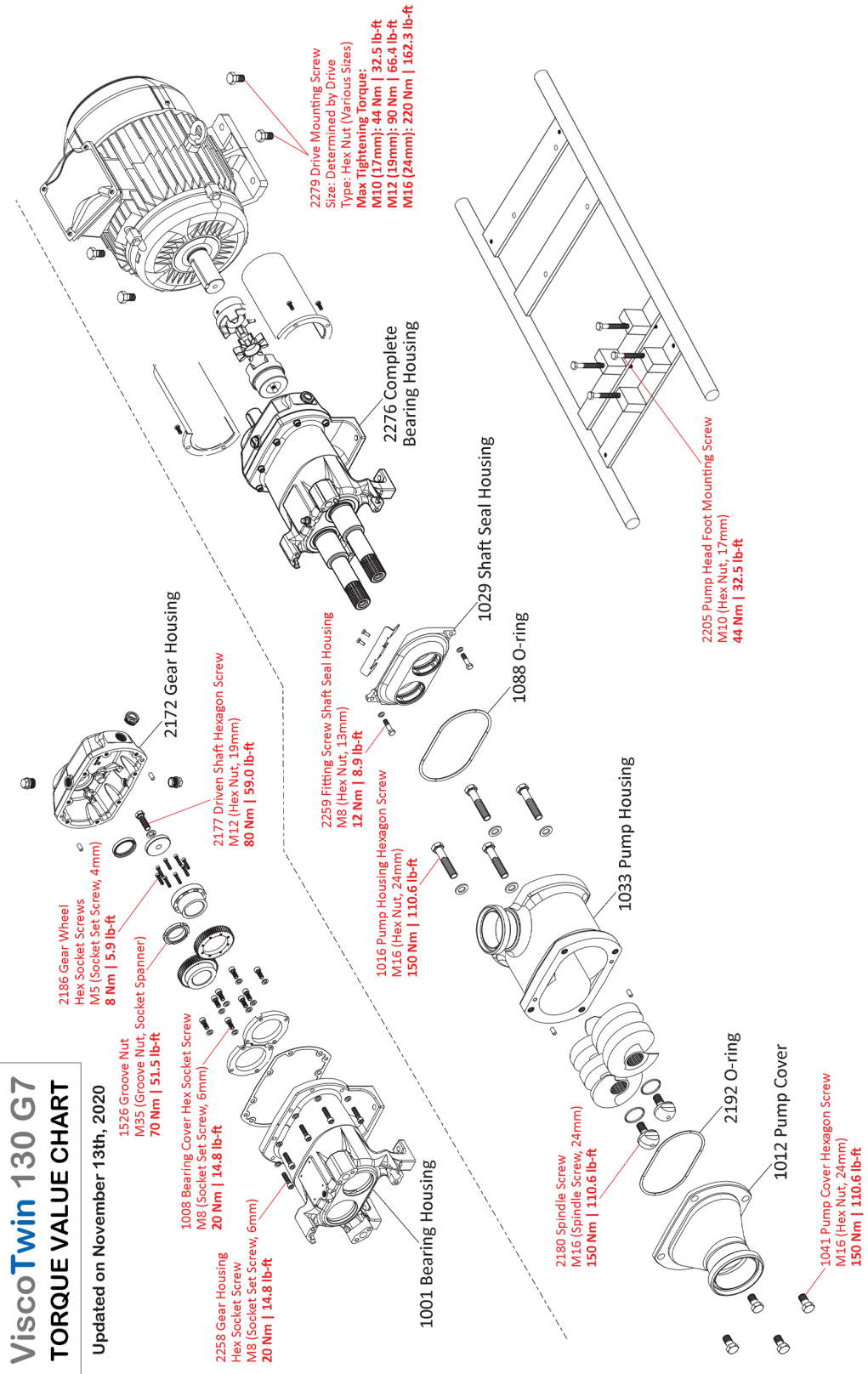

ViscoTwin 130 G7
TORQUE VALUE CHART

Updated on November 13th, 2020





4. SPARE PARTS ML2: VT130-G7

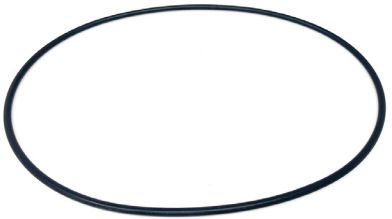

4.1 Pump Housing

| Spindle Screw_VT104, VT130_G7, G8, G9 | | | | Pos. 2180 |
|--|---------------------------|-----------------|----------------------|---|
| Part # | Customer Reference | Material | Specification |  |
| 18826 | | 316L | -- | |
| 23113 | | 316L | Hex Style | |
| NOTES: | | | | |

| O-Ring for Pump Face_VT130_G7, G8, G9 | | | | Pos. 2192 |
|--|---------------------------|-----------------|----------------------|---|
| Part # | Customer Reference | Material | Specification |  |
| 12516 | | FKM | DIN3771-185,6x4,0 | |
| 12520 | | EPDM | DIN3771-185,6x4,0 | |
| NOTES: | | | | |

| O-Ring for Spindle Screw_VT104, VT130_G7, G8, G9 | | | | Pos. 2194 |
|---|---------------------------|-----------------|----------------------|---|
| Part # | Customer Reference | Material | Specification |  |
| 12504 | | FKM | DIN3771-42x3,0 | |
| 12510 | | EPDM | DIN3771-42x3,0 | |
| NOTES: | | | | |

| Dowel Pin for Pump Face & Housing_VT70, VT104, VT130_G7, G8, G9 | | | | Pos. 2195, 2196 |
|--|---------------------------|-----------------|----------------------|---|
| Part # | Customer Reference | Material | Specification |  |
| 12616 | | 316L | DIN7-8h8x16 | |
| NOTES: | | | | |

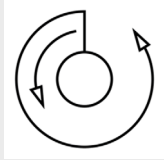
| Spindle Left Handed_G7, G8 | | | | Pos. 2200 |
|---|---------------------------|--|---------------------------------|---|
| Part # | Customer Reference | Specific Model Name | Material / Specification | |
| 21778 | | Spindle Left Handed_G7, G8_VT130.33SEH | 316L, 33mm,EH,Standard |  |
| 21781 | | Spindle Left Handed_G7, G8_VT130.33S3A | 316L, 33mm,3A,Standard | |
| 21777 | | Spindle Left Handed_G7, G8_VT130.33HEH | 316L, 33mm,EH,Hardened | |
| 17557 | | Spindle Left Handed_G7, G8_VT130.33H3A | 316L, 33mm,3A,Hardened | |
| 12636 | | Spindle Left Handed_G7, G8_VT130.44SEH | 316L, 44mm,EH,Standard |  |
| 18404 | | Spindle Left Handed_G7, G8_VT130.44S3A | 316L, 44mm,3A,Standard | |
| 15919 | | Spindle Left Handed_G7, G8_VT130.44HEH | 316L, 44mm,EH,Hardened | |
| 18459 | | Spindle Left Handed_G7, G8_VT130.44H3A | 316L, 44mm,3A,Hardened | |
| 12637 | | Spindle Left Handed_G7, G8_VT130.65SEH | 316L, 65mm,EH,Standard |  |
| 12638 | | Spindle Left Handed_G7, G8_VT130.65S3A | 316L, 65mm,3A,Standard | |
| 15920 | | Spindle Left Handed_G7, G8_VT130.65HEH | 316L, 65mm,EH,Hardened | |
| 21780 | | Spindle Left Handed_G7, G8_VT130.65H3A | 316L, 65mm,3A,Hardened | |
| <p>NOTES: Rotation Direction</p>  | | | | |

| Spindle Right Handed_G7, G8 | | | | Pos. 2201 |
|---|---------------------------|---|---------------------------------|---|
| Part # | Customer Reference | Specific Model Name | Material / Specification | |
| 21783 | | Spindle Right Handed_G7, G8_VT130.33SEH | 316L, 33mm,EH,Standard |  |
| 21782 | | Spindle Right Handed_G7, G8_VT130.33S3A | 316L, 33mm,3A,Standard | |
| 21784 | | Spindle Right Handed_G7, G8_VT130.33HEH | 316L, 33mm,EH,Hardened | |
| 21785 | | Spindle Right Handed_G7, G8_VT130.33H3A | 316L, 33mm,3A,Hardened | |
| 12643 | | Spindle Right Handed_G7, G8_VT130.44SEH | 316L, 44mm,EH,Standard | |
| 18405 | | Spindle Right Handed_G7, G8_VT130.44S3A | 316L, 44mm,3A,Standard | |
| 15921 | | Spindle Right Handed_G7, G8_VT130.44HEH | 316L, 44mm,EH,Hardened | |
| 18403 | | Spindle Right Handed_G7, G8_VT130.44H3A | 316L, 44mm,3A,Hardened | |
| 12642 | | Spindle Right Handed_G7, G8_VT130.65SEH | 316L, 65mm,EH,Standard |  |
| 12641 | | Spindle Right Handed_G7, G8_VT130.65S3A | 316L, 65mm,3A,Standard | |
| 15922 | | Spindle Right Handed_G7, G8_VT130.65HEH | 316L, 65mm,EH,Hardened | |
| 18460 | | Spindle Right Handed_G7, G8_VT130.65H3A | 316L, 65mm,3A,Hardened | |
| <p>NOTES: Rotation Direction</p>  | | | | |

4.2 Seal Housing

| O-Ring Seal Housing_VT130_G7, G8, G9 | | | | Pos. 1088 |
|---|---------------------------|-----------------|----------------------|---|
| Part # | Customer Reference | Material | Specification |  |
| 12515 | | FKM | DIN3771-180x6,0 | |
| 12519 | | EPDM | DIN3771-180x6,0 | |
| NOTES: | | | | |

| Elastomer Kit SAMS_VT130_G7 | | | | Pos. 2261 BF |
|------------------------------------|--------------------|----------|-----------------|---|
| Part # | Customer Reference | Material | Specification |  |
| 18823 | | FKM | ANGA, SD: 55 mm | |
| 22137 | | EPDM | ANGA, SD: 55 mm | |
| NOTES: | | | | |

| Elastomer Kit SAMS_VT130_G7 | | | | Pos. 2261 BF |
|------------------------------------|--------------------|----------|---------------------|---|
| Part # | Customer Reference | Material | Specification |  |
| 12517 | | FKM | HUHNSEAL, SD: 55 mm | |
| 12518 | | EPDM | HUHNSEAL, SD: 55 mm | |
| NOTES: | | | | |

| Elastomer Kit DAMS_VT130_G7 | | | | Pos. 2261 BC |
|------------------------------------|--------------------|----------|-----------------|---|
| Part # | Customer Reference | Material | Specification |  |
| 18544 | | FKM | ANGA, SD: 55 mm | |
| 18545 | | EPDM | ANGA, SD: 55 mm | |
| NOTES: | | | | |

| Elastomer Kit DAMS_VT130_G7 | | | | Pos. 2261 BC |
|------------------------------------|--------------------|----------|---------------------|---|
| Part # | Customer Reference | Material | Specification |  |
| 18447 | | FKM | HUHNSEAL, SD: 55 mm | |
| 18448 | | EPDM | HUHNSEAL, SD: 55 mm | |
| NOTES: | | | | |

| Mechanical Seal SAMS_VT130_G7 | | | | Pos. 1303 BF |
|--------------------------------------|--------------------|----------------|-----------------|---|
| Part # | Customer Reference | Material | Specification |  |
| 5008 | S3 | SIC/SIC FKM | ANGA, SD: 55 mm | |
| 8288 | S3 | SIC/SIC EPDM | ANGA, SD: 55 mm | |
| 18724 | S4 | TuC/TuCKE FKM | ANGA, SD: 55 mm | |
| 6668 | S4 | TuC/TuCKE EPDM | ANGA, SD: 55 mm | |
| 22123 | SX4 | TuC/Tu FKM | ANGA, SD: 55 mm | |
| NOTES: | | | | |

| Mechanical Seal SAMS_VT130_G7 | | | | Pos. 1303 BF |
|--------------------------------------|--------------------|----------------|---------------------|---|
| Part # | Customer Reference | Material | Specification |  |
| 11750 | S1 | SIC/SIC FKM | HUHNSEAL, SD: 55 mm | |
| 5656 | S1 | SIC/SIC EPDM | HUHNSEAL, SD: 55 mm | |
| 11459 | S2 | TuC/TuCKE FKM | HUHNSEAL, SD: 55 mm | |
| 7150 | SX2 | TuC/TuCKE EPDM | HUHNSEAL, SD: 55 mm | |
| NOTES: | | | | |

| Mechanical Seal DAMS_VT130_G7 | | | | Pos. 1303 BC |
|--------------------------------------|--------------------|----------------|-----------------|---|
| Part # | Customer Reference | Material | Specification |  |
| 17548 | D3 | SIC/SIC FKM | ANGA, SD: 55 mm | |
| 19450 | D3 | SIC/SIC EPDM | ANGA, SD: 55 mm | |
| 19452 | D4 | TuC/TuCKE FKM | ANGA, SD: 55 mm | |
| 19451 | D4 | TuC/TuCKE EPDM | ANGA, SD: 55 mm | |
| 19449 | DX4 | TuC/Tu FKM | ANGA, SD: 55 mm | |
| NOTES: | | | | |

| Mechanical Seal DAMS_VT130_G7 | | | | Pos. 1303 BC |
|--------------------------------------|--------------------|----------------|---------------------|---|
| Part # | Customer Reference | Material | Specification |  |
| 19281 | D1 | SIC/SIC FKM | HUHNSEAL, SD: 55 mm | |
| 11777 | D1 | SIC/SIC EPDM | HUHNSEAL, SD: 55 mm | |
| 17549 | D2 | TuC/TuCKE FKM | HUHNSEAL, SD: 55 mm | |
| 17013 | D2 | TuC/TuCKE EPDM | HUHNSEAL, SD: 55 mm | |
| 21661 | DX2 | TuC/Tu FKM | HUHNSEAL, SD: 55 mm | |
| NOTES: | | | | |

4.3 Bearing Housing

| Shaft Sealing Ring Bearing Housing_VT130_G7 | | | | Pos. 1111 |
|--|---------------------------|-----------------|----------------------------------|---|
| Part # | Customer Reference | Material | Specification |  |
| 12531 | | FKM | DIN3760-AS-60x75x8, SD: 55 mm | |
| NOTES: | | | | |

| Key for Coupling_VT130_G7, G8, G9 | | | | Pos. 1183 |
|--|---------------------------|-----------------|----------------------|---|
| Part # | Customer Reference | Material | Specification |  |
| 12619 | | 304 | DIN6885-AS 10x8x45 | |
| NOTES: | | | | |

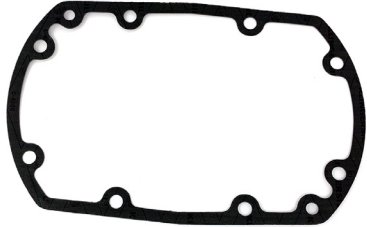
| Flat Gasket Gear Housing_VT130_G7 | | | | Pos. 2198 |
|--|---------------------------|-----------------|----------------------|---|
| Part # | Customer Reference | Material | Specification |  |
| 12494 | | -- | 1 mm | |
| NOTES: | | | | |

4.4 Gear Housing

| Shaft Sealing Ring Gear Housing_VT130_G7 | | | | Pos. 1010 |
|---|---------------------------|-----------------|----------------------------------|---|
| Part # | Customer Reference | Material | Specification |  |
| 12532 | | FKM | DIN3760-AS 42x55x8, SD: 55 mm | |
| NOTES: | | | | |

| Oil Level Sight Gauge_VT70, VT104, VT130_G7, G8, G9 | | | | Pos. 1541 |
|--|---------------------------|---------------------|----------------------|---|
| Part # | Customer Reference | Material | Specification |  |
| 21766 | | Aluminium, Glass | G3/4" | |
| NOTES: | | | | |

| Magnetic Screw Plug_VT70, VT104, VT130_G7 | | | | Pos. 2233 |
|--|--------------------|-----------|---------------|---|
| Part # | Customer Reference | Material | Specification |  |
| 18756 | | Aluminium | DIN910-G 1/2" | |
| NOTES: | | | | |

| Gear Oil Bearing Housing VT | | | |  |
|------------------------------------|--------------------|----------|---------------|--|
| Part # | Customer Reference | Material | Specification | |
| 21871 | | -- | 5 L | |
| NOTES: | | | | |

4.5 Drive Train

| Coupling Hub Pump_VT130_G7 | | | | Pos. 2247 |
|-----------------------------------|-----------------------------|-----------------|----------------------|---|
| Part # | Specific Model Name | Material | Specification |  |
| 22113 | Coupling Hub Pump_ AL100_G7 | Aluminium | AL100 , BS: 35 mm | |
| 6741 | Coupling Hub Pump_ AL110_G7 | Aluminium | AL110 , BS: 35 mm | |
| 6742 | Coupling Hub Pump_ AL150_G7 | Aluminium | AL150 , BS: 35 mm | |
| NOTES: | | | | |

| Coupling Hub Motor_VT130_G7 | | | | Pos. 2248 |
|---|---------------------------|-----------------|----------------------|---|
| Part # | Customer Reference | Material | Specification |  |
| various | | Aluminium | variable | |
| NOTES: Size might change due to motor size. Please consult configuration key or contact Processtec Inc. | | | | |

| Coupling Spider_VT104, VT130_G7 | | | | Pos. 2249 |
|--|---------------------------|-------------------------------|--|---|
| Part # | Customer Reference | Specific Model Name | Specification |  |
| 6751 | | Coupling Spider_L100_G7 | Elastomer NBR Lovejoy, Model L100 Solid Type | |
| 6752 | | Coupling Spider_L110_G7 | Elastomer NBR Lovejoy, Model L110 Solid Type | |
| 16554 | | Coupling Spider_L150_8star_G7 | Elastomer NBR Lovejoy, Model L150 Solid Type | |
| NOTES: | | | | |

| W22 Severe Duty Motor | | | | Pos. 3003 |
|---|---------------------------|-----------------|----------------------|---|
| Part # | Customer Reference | Material | Specification |  |
| | | CI | variable | |
| NOTES: <i>WEG Severe Duty 25 HP Size might change due to application requirements</i> | | | | |