

# Cleaning-In-Place Accessories

Equipment Needed to Transition  
from Hand Cleaning to CIP



---

# The ALL NEW ViscoClean 2.0 CIP Valve

---

*The ViscoClean 2.0 uses a shorter Pneumatic Actuator, which allows for steam injection, and can also be used as a Sampling Valve.*



ViscoClean 2.0  
Updated Housing

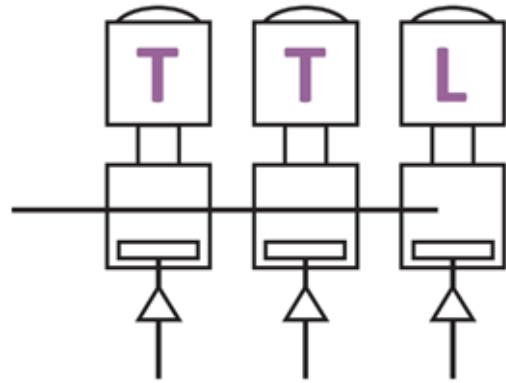

T-Housing and L-Housing

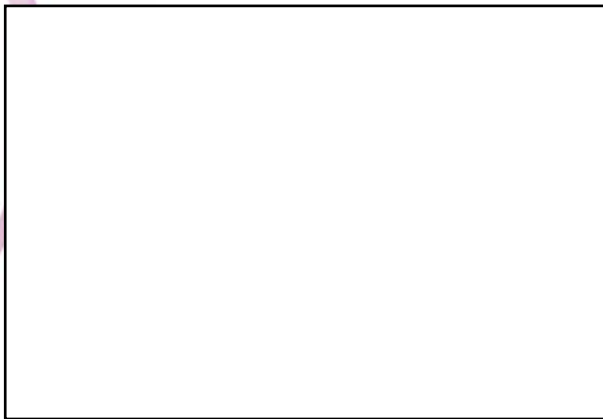

ViscoClean 2.0 with Control Top

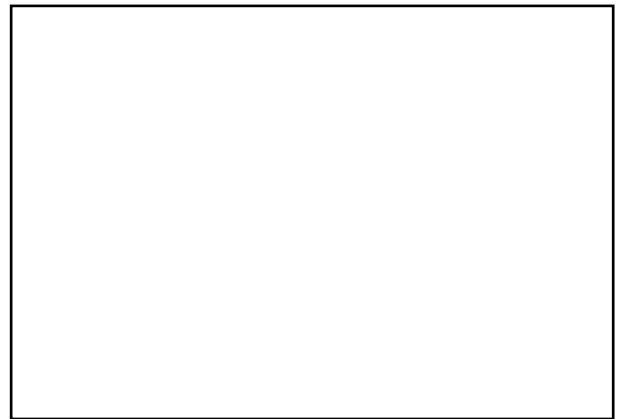

ViscoClean 2.0 without Control Top



Angled Tank Installation

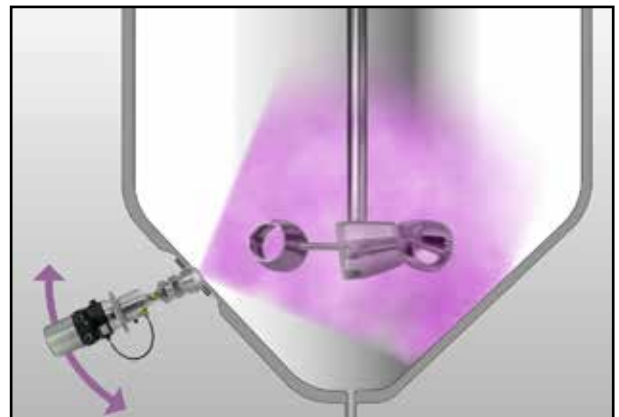

Angled Tank Installation

---

---

# PT-2-Stroke CIP Valve

---

*Achieves a Disc Spray pattern, without the use of a Pneumatic Actuator.  
Allows for automatic draining in idle position.*



## PT2S-10

**10 GPM (@ 30psi) with  
Multi-Flange Installation**

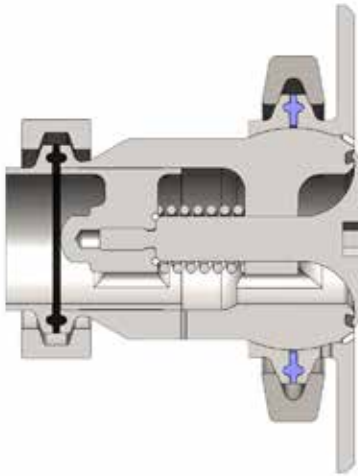

## PT2S-40

**40 GPM with  
Multi-Flange Installation**

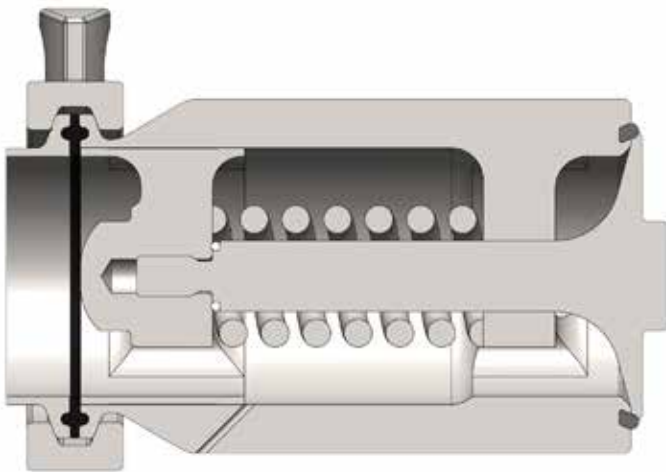

## PT2S-100

**100 GPM with  
Welded Installation**

---

# Flush Mount Pipe Connections



## Flush Mount Tube (-3) Clamp Connection

(ENTER A SMALL AMOUNT OF DESCRIPTIVE TEXT HERE, EXPLAINING THE FEATURES AND FUNCTION OF THE FLUSH MOUNT TUBE PIPE CONNECTION).

EXAMPLE: FOR USE IN TIGHT SPACES, WHERE UPSTREAM AND DOWNSTREAM PIPING IS NOT EASILY DISCONNECTED.

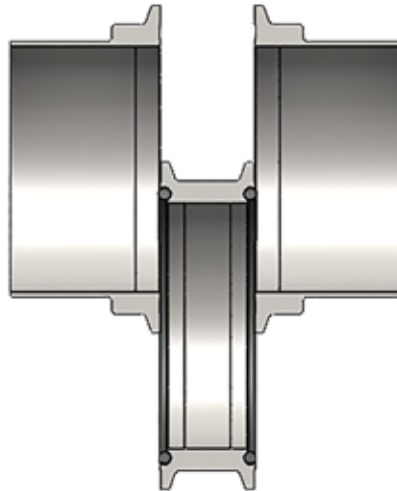
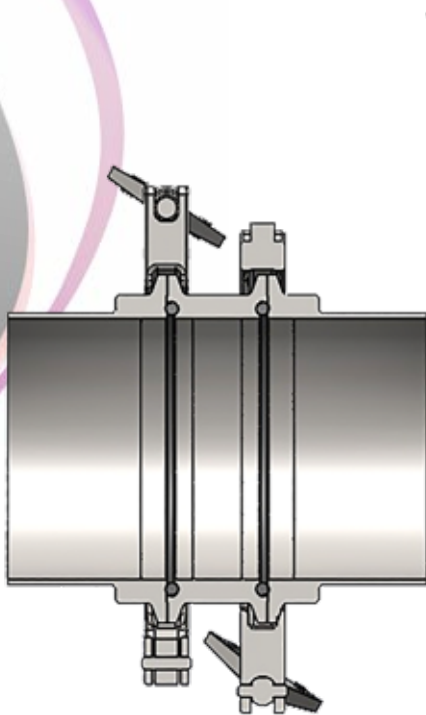

## Flush Mount Joint (-3) Clamp Connection

(ENTER A SMALL AMOUNT OF DESCRIPTIVE TEXT HERE, EXPLAINING THE FEATURES AND FUNCTION OF THE FLUSH MOUNT JOINT PIPE CONNECTION).

EXAMPLE: FOR USE IN TIGHT SPACES, WHERE UPSTREAM AND DOWNSTREAM PIPING IS NOT EASILY DISCONNECTED.

**FLUSH MOUNT PIPE CONNECTIONS are available in these sizes:**

PTTJ-3  
OD1"

PTTJ-3  
OD1.5"

PTTJ-3  
OD2"

PTTJ-3  
OD2.5"

PTTJ-3  
OD3"

PTTJ-3  
OD4"

---

# Tube Expansion Compensator<sup>®</sup>

---

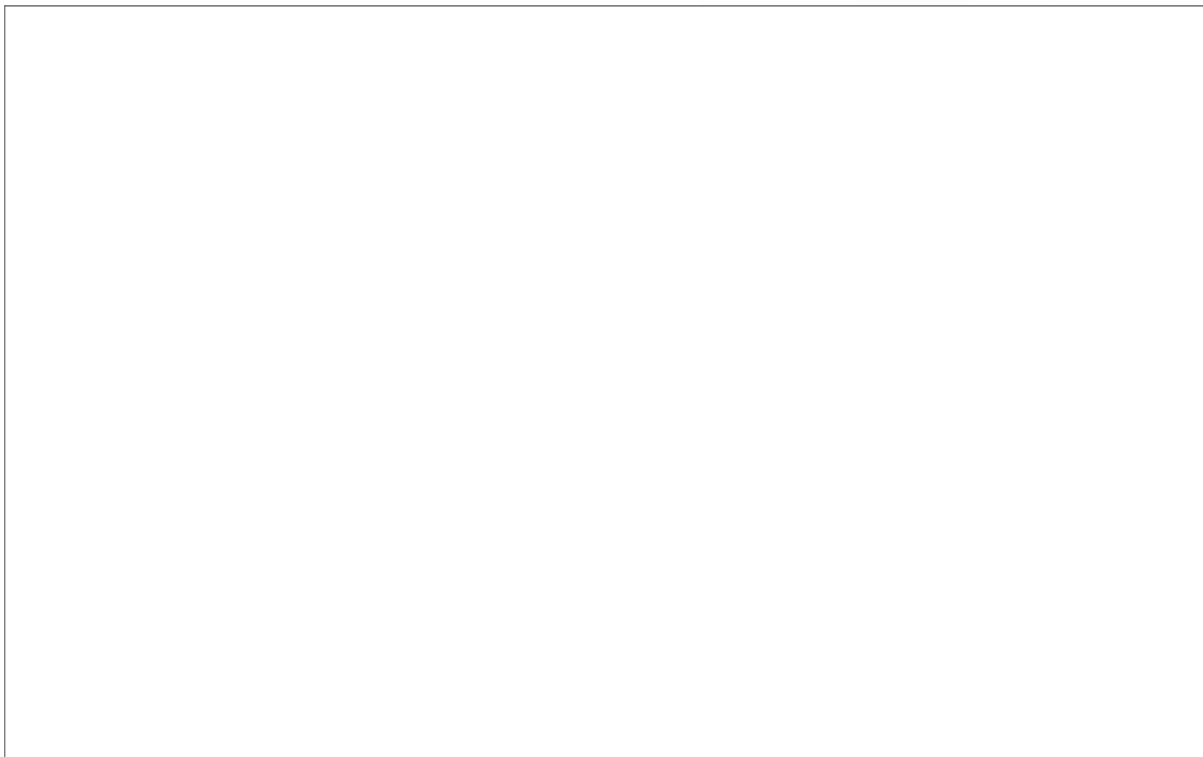

**PTTC-3 OD3"**

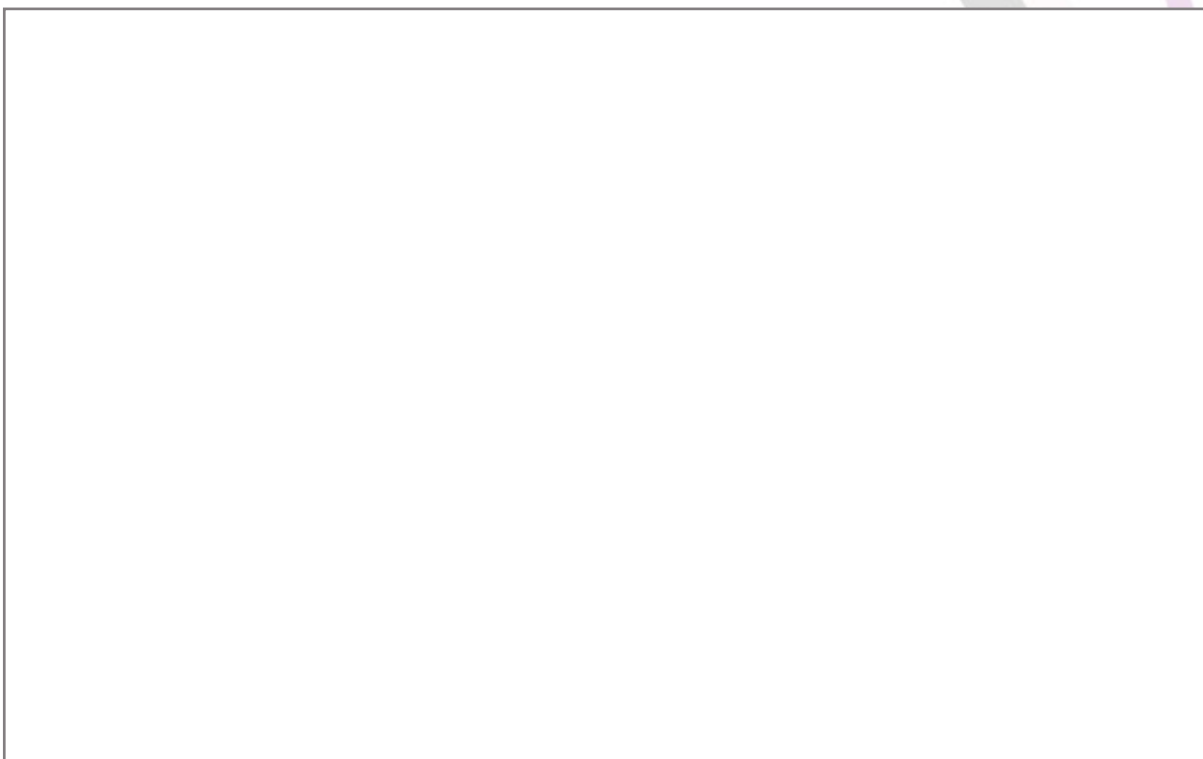

**PTTC-3 OD4"**

---

---

# PROCESSTEC Multi-Flange

---

**ONE SIZE FITS ALL!**

*The same size of PT-Multi-Flange can be used for a variety of applications*

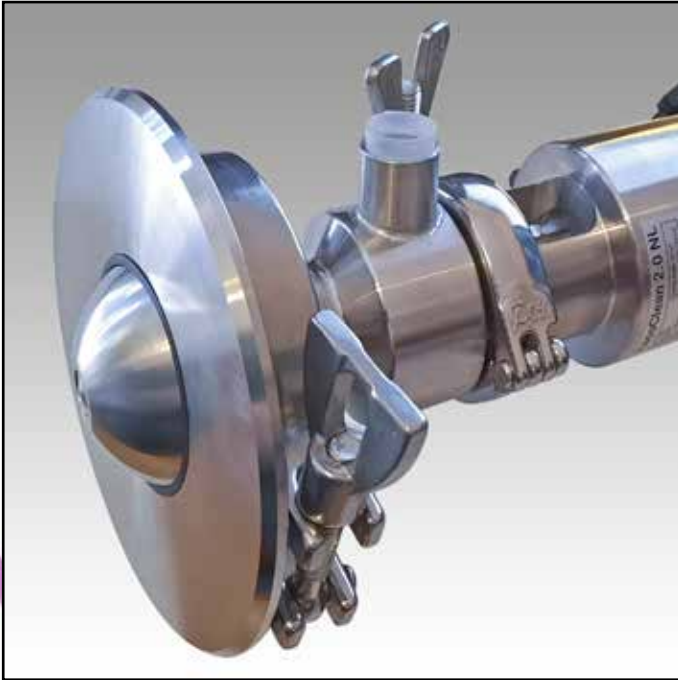

**ViscoClean 2.0  
with Multi-Flange**

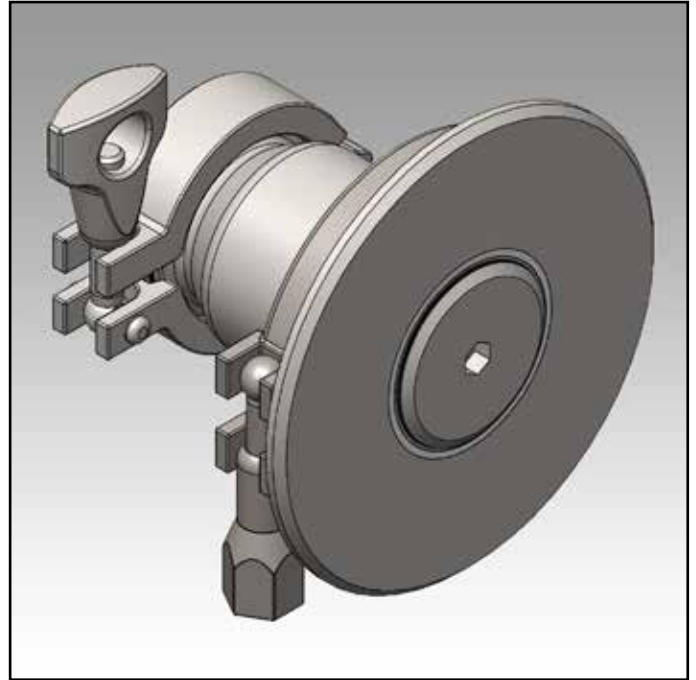

**PT2S-40 2-Stroke  
with Multi-Flange**

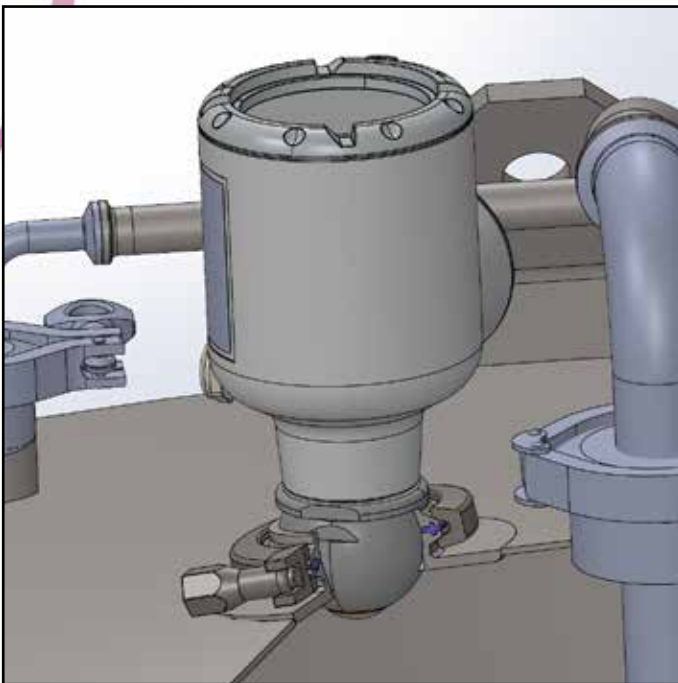

**Krohne Radar Sensor  
with Multi-Flange**

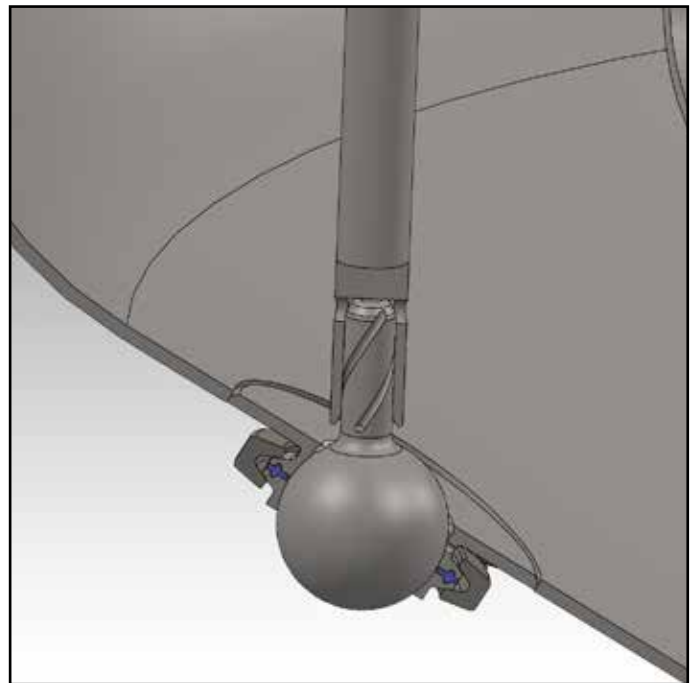

**Baffle Guide  
with Multi-Flange**

---



---

# GS-Fusion 50mm

---

***ONE SIZE FITS ALL!***

GS = Gearbox & Seal, Combined into one!

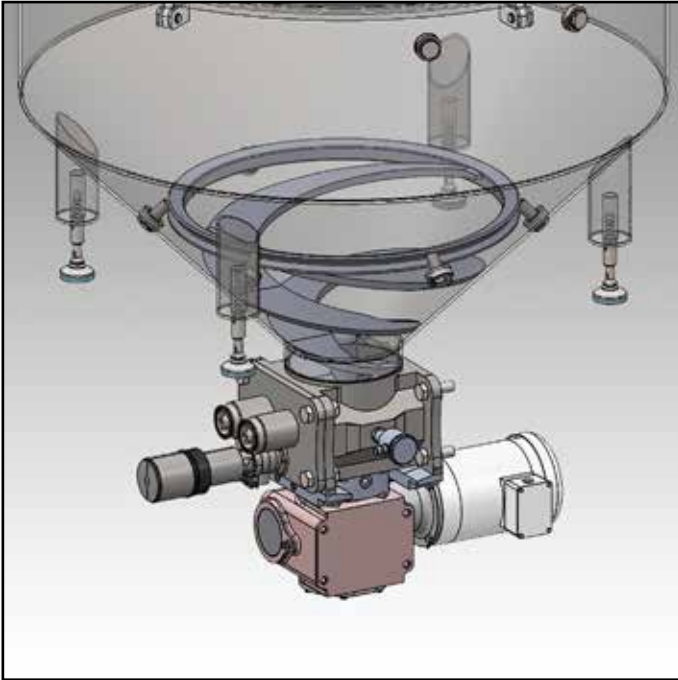

**GS-Fusion used with  
Auger Housing**

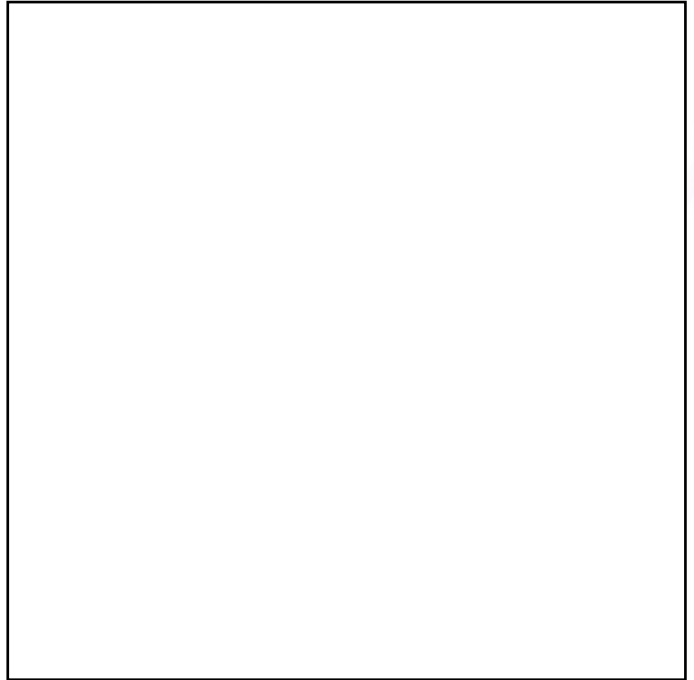

**GS-Fusion used with  
Mix Tank Housing**

*[Insert Text here about the GS-Fusion  
being a solution for sanitary design.]*

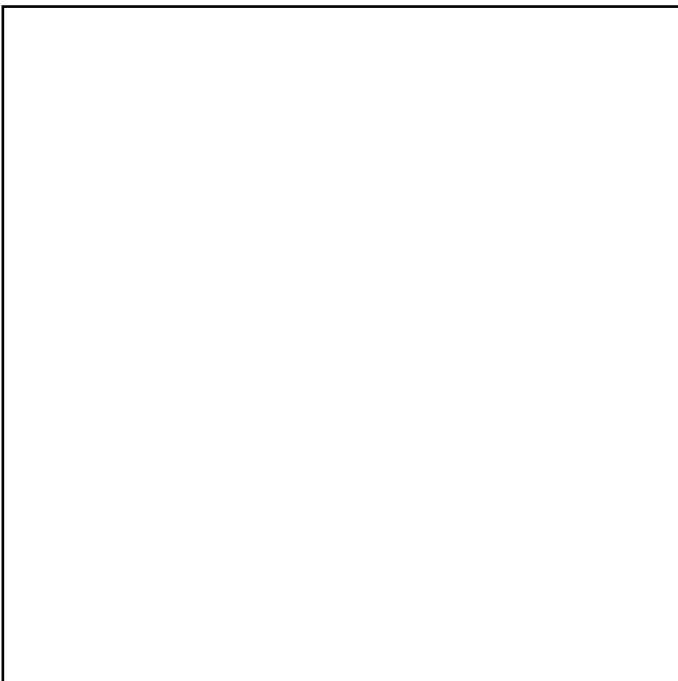

**GS-Fusion used with  
Smart Connect Housing**



## Some of the Industries we Serve

---



DAIRY



JUICES



FRUITS



PERSONAL  
CARE



TOMATO



BEVERAGES



SAUCES



INFANT  
FORMULA



PROCESSED  
FOODS



PROCESSED  
MEAT



BAKERY



CONFECT-  
IONERY



PASTRIES



OILS



FRAGRANCE



CHEMICALS



PAINTS



VARNISHES



OINTMENTS



PHARMA-  
CEUTICALS

---

**PROCESSTEC, Inc.**

345 East Tulare Ave. Unit E  
Visalia, CA 93277

**Phone:** +1 (559) 429-4227

**Fax:** +1 (559) 429-4228

**Email:** [info@processtec.com](mailto:info@processtec.com)

<http://processtec.com>