

# SPARE PARTS

ViscoTwin

# VT104

G10, V1

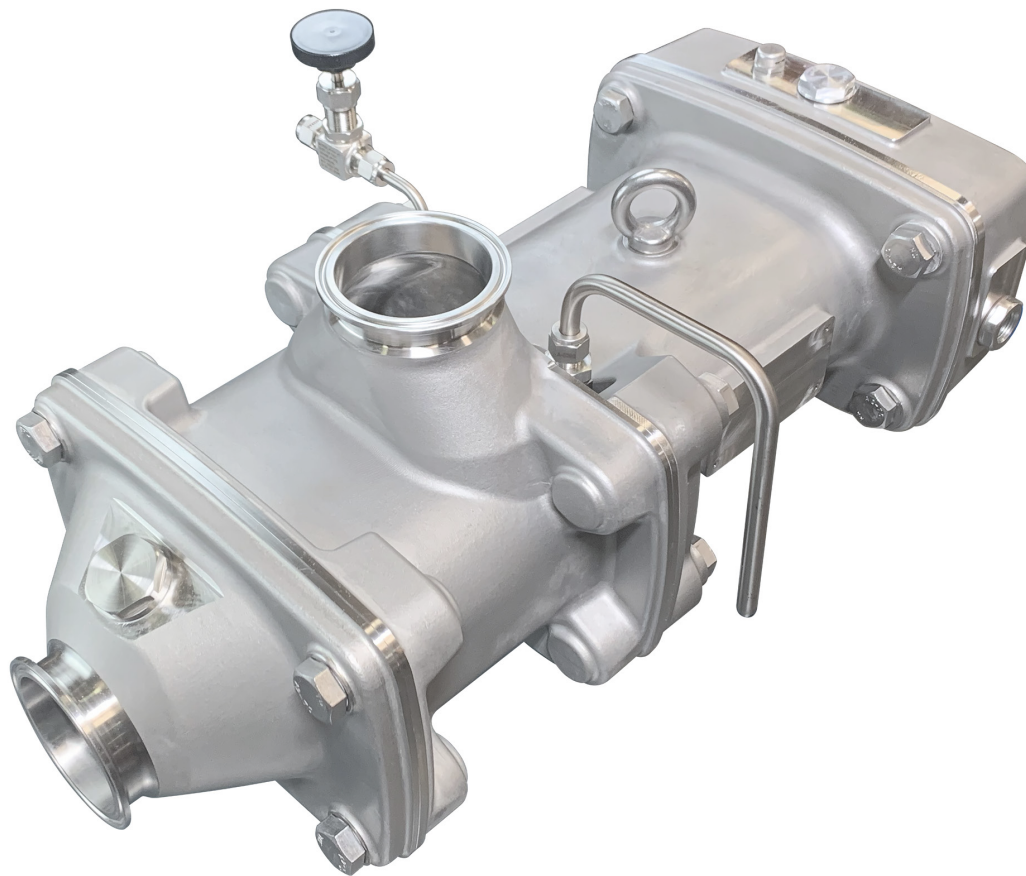

**PROCESSTEC**  
GET TOMORROW'S TECHNOLOGY TODAY

[processtec.com](http://processtec.com)  
[info@processtec.com](mailto:info@processtec.com)

9938 W Legacy Ave  
Visalia, CA 93291  
Phone +1 (559) 429 - 4227  
Fax +1 (559) 429 - 4228

**1. OVERVIEW DRAWING ..... 3**

**2. EXPLOSION DRAWING ..... 4**

**3. TORQUE VALUES. .... 5**

**4. SPARE PARTS. .... 6**

**4.1 Pump Housing. .... 6**

**4.2 Seal Housing ..... 15**

**4.3 Bearing Housing ..... 21**

**4.4 Gear Housing. .... 32**

**1. OVERVIEW DRAWING**

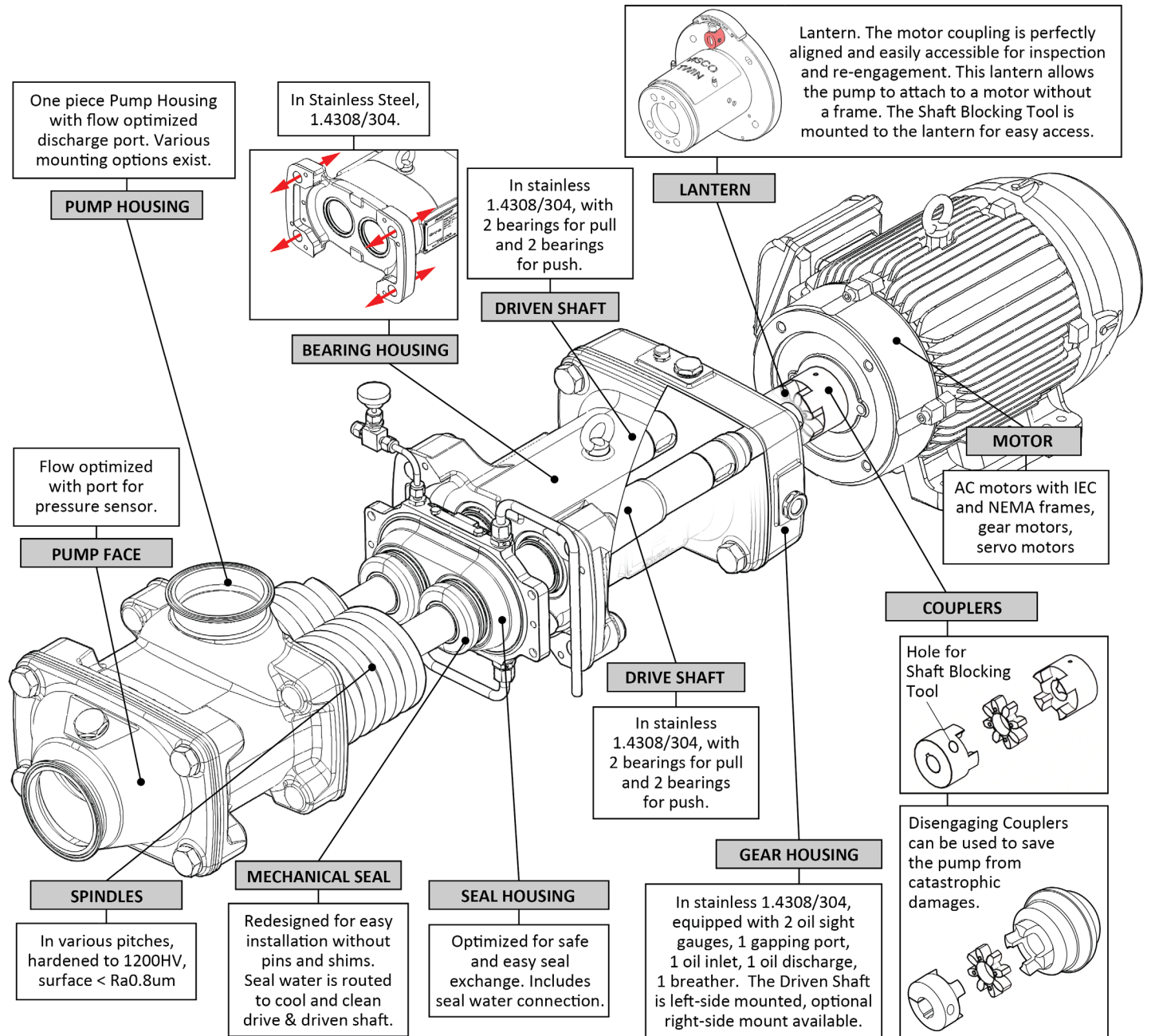

**2. EXPLOSION DRAWING**

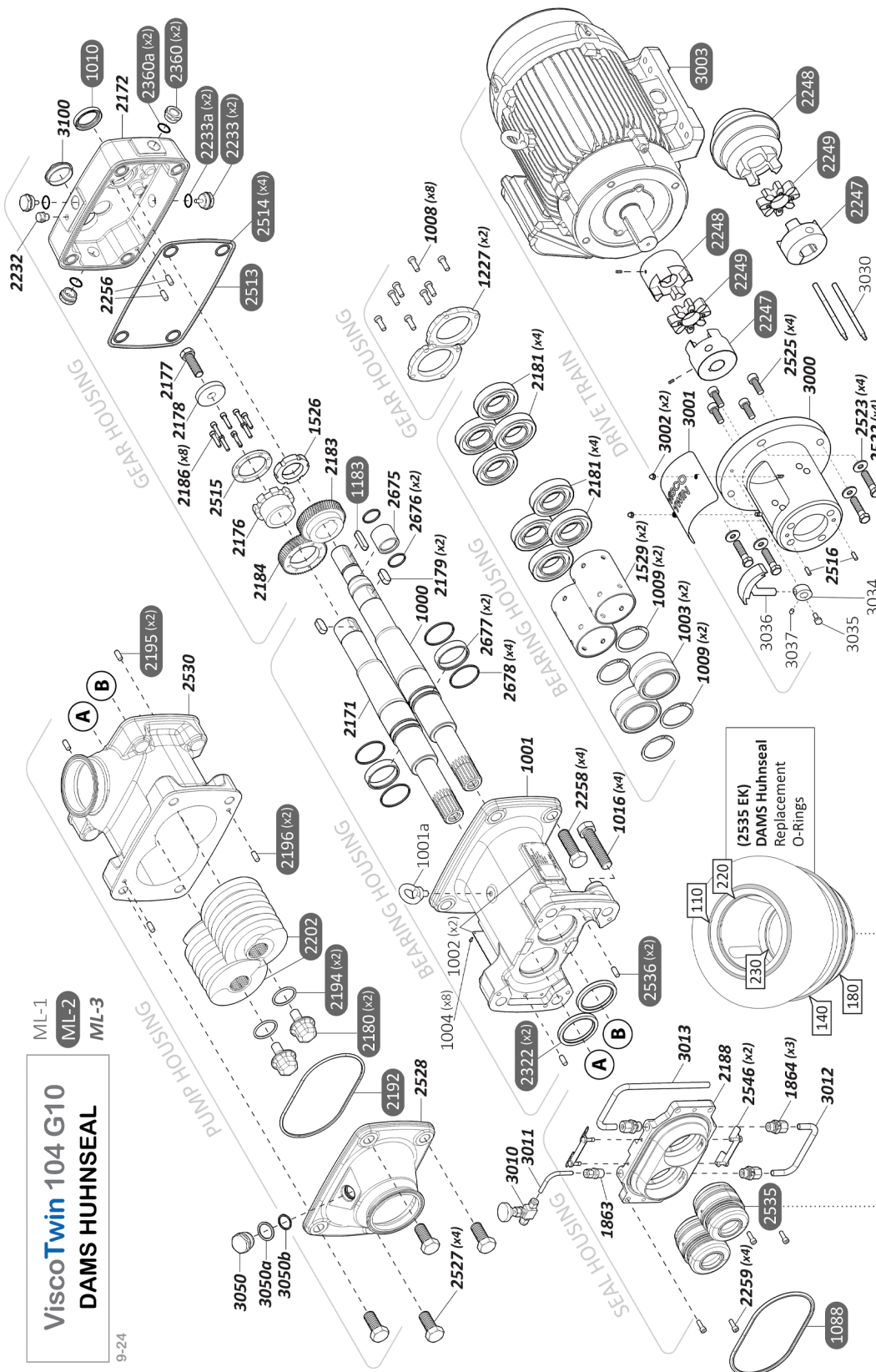

**3. TORQUE VALUES**

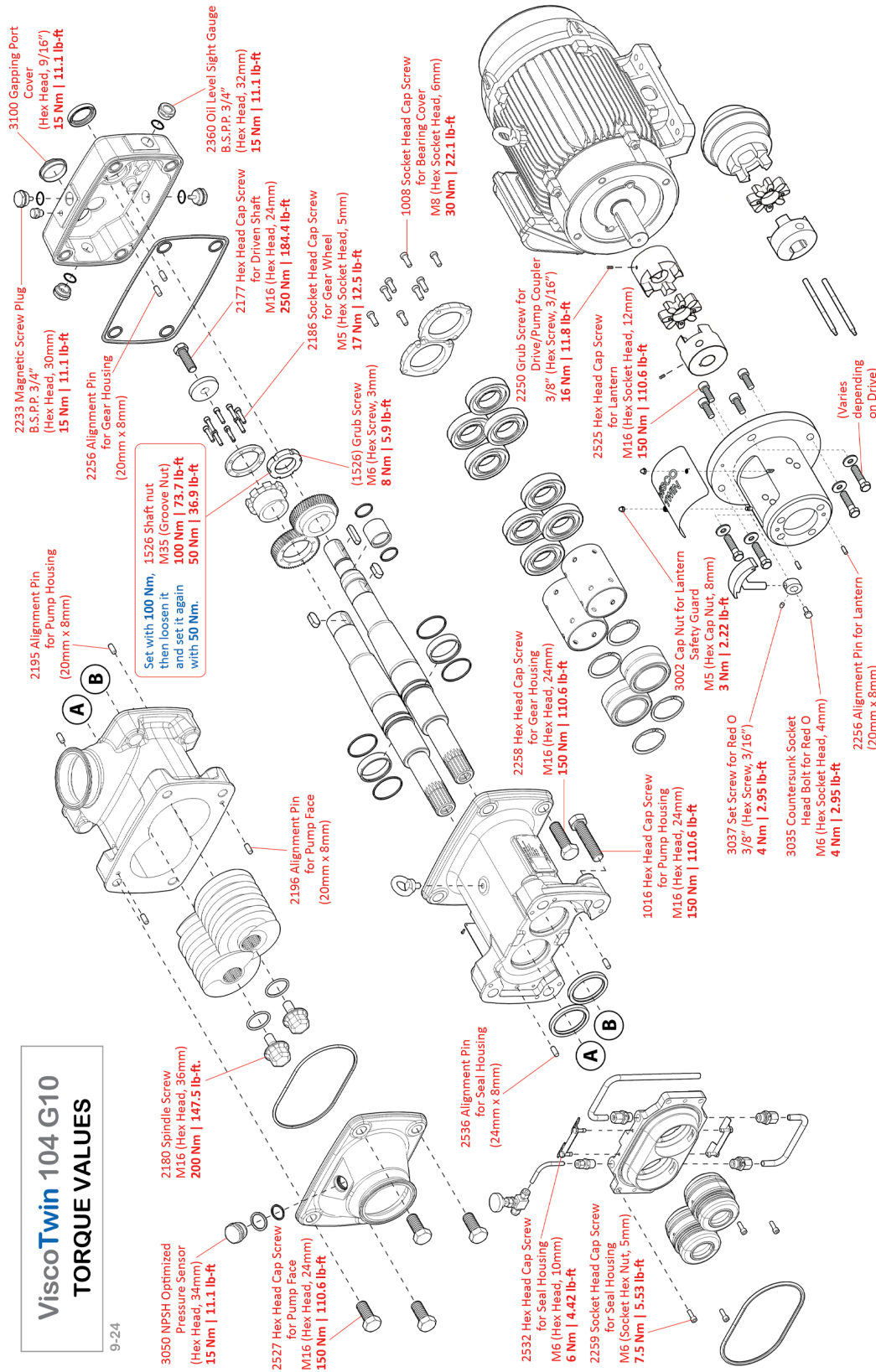

**ViscoTwin 104 G10**  
**TORQUE VALUES**  
9-24





**4. SPARE PARTS**

**4.1 Pump Housing**

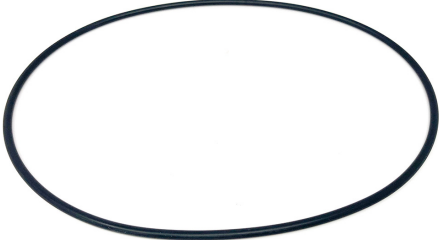
<b>VT104 G10</b>	<b>Spindle Bolt</b>	<b>POS. 2180</b>
<b>PART #</b>	<b>23113</b>	
<b>CUSTOMER REFERENCE #</b>		
<b>MATERIAL</b>	2205	
<b>SPECS</b>	Hex Style	
<b>NOTES</b>	--	

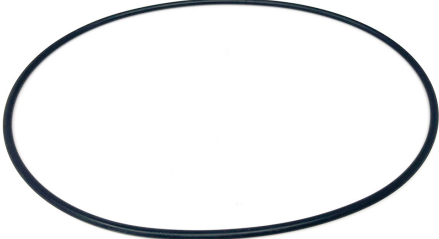
<b>VT104 G10</b>	<b>O-Ring for Pump Face</b>	<b>POS. 2192</b>
<b>PART #</b>	<b>12505</b>	
<b>CUSTOMER REFERENCE #</b>		
<b>MATERIAL</b>	FKM	
<b>SPECS</b>	155 x 4mm	
<b>NOTES</b>	--	

<b>VT104 G10</b>	<b>O-Ring for Pump Face</b>	<b>POS. 2192</b>
<b>PART #</b>	<b>12511</b>	
<b>CUSTOMER REFERENCE #</b>		
<b>MATERIAL</b>	EPDM	
<b>SPECS</b>	155 x 4mm	
<b>NOTES</b>	--	

<b>VT104 G10</b>	<b>O-Ring for Spindle Bolt</b>	<b>POS. 2194</b>
<b>PART #</b>	<b>12504</b>	
<b>CUSTOMER REFERENCE #</b>		
<b>MATERIAL</b>	FKM	
<b>SPECS</b>	42 x 3mm	
<b>NOTES</b>	--	

<b>VT104 G10</b>	<b>O-Ring for Spindle Bolt</b>	<b>POS. 2194</b>
<b>PART #</b>	<b>12510</b>	
<b>CUSTOMER REFERENCE #</b>		
<b>MATERIAL</b>	EPDM	
<b>SPECS</b>	42 x 3mm	
<b>NOTES</b>	--	

<b>VT104 G10</b>	<b>Dowel Pin for Pump Face &amp; Housing</b>	<b>POS. 2195, 2196</b>
<b>PART #</b>	<b>12616</b>	
<b>CUSTOMER REFERENCE #</b>		
<b>MATERIAL</b>	303	
<b>SPECS</b>	DIN7 - 8 h 8 x 20mm, undersize	
<b>NOTES</b>	--	



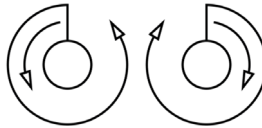

<b>VT104 G10</b>	<b>Spindle Pair VT104.27</b>	<b>POS. 2202</b>
<b>PART #</b>	<b>12639</b>	
<b>CUSTOMER REFERENCE #</b>		
<b>MATERIAL</b>	316L	
<b>SPECS</b>	27mm, hardened	
<b>NOTES</b>		

<b>VT104 G10</b>	<b>Spindle Pair VT104.36</b>	<b>POS. 2202</b>
<b>PART #</b>	<b>18489</b>	
<b>CUSTOMER REFERENCE #</b>		
<b>MATERIAL</b>	316L	
<b>SPECS</b>	36mm, hardened	
<b>NOTES</b>		

<b>VT104 G10</b>	<b>Spindle Pair VT104.53</b>	<b>POS. 2202</b>
<b>PART #</b>	<b>17516</b>	
<b>CUSTOMER REFERENCE #</b>		
<b>MATERIAL</b>	316L	
<b>SPECS</b>	53mm, hardened	
<b>NOTES</b>		

<b>VT104 G10</b>	<b>Hex Head Cap Screw for Pump Face</b>	<b>POS. 2527</b>
<b>PART #</b>	<b>24888</b>	
<b>CUSTOMER REFERENCE #</b>		
<b>MATERIAL</b>	A2-70	
<b>SPECS</b>	M16 - 2 x 45mm	
<b>NOTES</b>	--	

<b>VT104 G10</b>	<b>Pump Face OD3"</b>	<b>POS. 2528</b>
<b>PART #</b>	<b>23645</b>	
<b>CUSTOMER REFERENCE #</b>		
<b>MATERIAL</b>	PF:FC316	
<b>SPECS</b>	PF:OD3", Tri-Clamp	
<b>NOTES</b>	With Gauge Port	

<b>VT104 G10</b>	<b>Pump Face OD4"</b>	<b>POS. 2528</b>
<b>PART #</b>	<b>23646</b>	
<b>CUSTOMER REFERENCE #</b>		
<b>MATERIAL</b>	PF:FC316L	
<b>SPECS</b>	PF:OD4", Tri-Clamp	
<b>NOTES</b>	With Gauge Port	

<b>VT104 G10</b>	<b>Pump Housing OD2-1/2"</b>	<b>POS. 2530</b>
<b>PART #</b>	<b>23680</b>	
<b>CUSTOMER REFERENCE #</b>		
<b>MATERIAL</b>	FC316L	
<b>SPECS</b>	PCP:OD2-1/2" Tri-Clamp	
<b>NOTES</b>	--	

<b>VT104 G10</b>	<b>Pump Housing OD3"</b>	<b>POS. 2530</b>
<b>PART #</b>	<b>23644</b>	
<b>CUSTOMER REFERENCE #</b>		
<b>MATERIAL</b>	FC316L	
<b>SPECS</b>	PCP: OD3", Tri-Clamp	
<b>NOTES</b>	--	

<b>VT104 G10</b>	<b>Aseptoflex Plug for Sensor Port</b>	<b>POS. 3050</b>
<b>PART #</b>	<b>22252</b>	
<b>CUSTOMER REFERENCE #</b>		
<b>MATERIAL</b>	316L	
<b>SPECS</b>	--	
<b>NOTES</b>	--	

<b>VT104 G10</b>	<b>Gasket for Aseptoflex Plug (green)</b>	<b>POS. 3050 a</b>
<b>PART #</b>	<b>22948</b>	
<b>CUSTOMER REFERENCE #</b>		
<b>MATERIAL</b>	FKM	
<b>SPECS</b>	ID: 29.7mm x OD: 35.7mm	
<b>NOTES</b>	--	

<b>VT104 G10</b>	<b>O-Ring for Aseptoflex Plug</b>	<b>POS. 3050 b</b>
<b>PART #</b>	<b>22253</b>	
<b>CUSTOMER REFERENCE #</b>		
<b>MATERIAL</b>	FKM	
<b>SPECS</b>	O-ring: 24 x 2mm (FKM), in contact with the medium	
<b>NOTES</b>	--	

**4.2 Seal Housing**

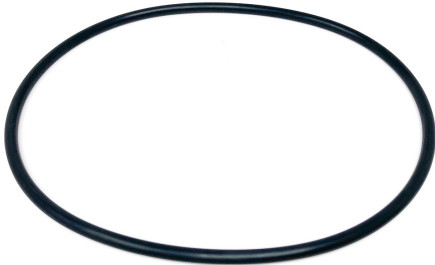
<b>VT104 G10</b>	<b>O-Ring Seal Housing</b>	<b>POS. 1088</b>
<b>PART #</b>	<b>12503</b>	
<b>CUSTOMER REFERENCE #</b>		
<b>MATERIAL</b>	FKM	
<b>SPECS</b>	142 x 6.2mm	
<b>NOTES</b>	--	

<b>VT104 G10</b>	<b>O-Ring Seal Housing</b>	<b>POS. 1088</b>
<b>PART #</b>	<b>12512</b>	
<b>CUSTOMER REFERENCE #</b>		
<b>MATERIAL</b>	EPDM	
<b>SPECS</b>	142 x 6.2mm	
<b>NOTES</b>	--	

<b>VT104 G10</b>	<b>Elastomer Kit DAMS</b>	<b>POS. 2535 EK</b>
<b>PART #</b>	<b>24918</b>	
<b>CUSTOMER REFERENCE #</b>		
<b>MATERIAL</b>	FKM	
<b>SPECS</b>	HUHNSEAL, SD: 42mm	
<b>NOTES</b>	--	

<b>VT104 G10</b>	<b>Mechanical Seal DAMS</b>	<b>POS. 2535</b>
<b>PART #</b>	<b>23673</b>	
<b>CUSTOMER REFERENCE #</b>		
<b>MATERIAL</b>	AE:316Ti/AE:SiC/NPS:C, NPS:E/AE:FKM	
<b>SPECS</b>	HUHNSEAL, SD: 42mm	
<b>NOTES</b>	--	



<b>VT104 G10</b>	<b>Mechanical Seal DAMS</b>	<b>POS. 2535</b>
<b>PART #</b>	<b>23850</b>	
<b>CUSTOMER REFERENCE #</b>		
<b>MATERIAL</b>	AE:316Ti/AE:SiC/NPS:C, AE:E/NPS:E	
<b>SPECS</b>	HUHNSEAL, SD: 42mm	
<b>NOTES</b>	--	

<b>VT104 G10</b>	<b>Mechanical Seal DAMS</b>	<b>POS. 2535</b>
<b>PART #</b>	<b>23555</b>	
<b>CUSTOMER REFERENCE #</b>		
<b>MATERIAL</b>	AE:316Ti/AE:TuChne/AE:TuC, NPS:E/AE:FKM	
<b>SPECS</b>	HUHNSEAL, SD: 42mm	
<b>NOTES</b>	--	

<b>VT104 G10</b>	<b>Mechanical Seal DAMS</b>	<b>POS. 2535</b>
<b>PART #</b>	<b>21566</b>	
<b>CUSTOMER REFERENCE #</b>		
<b>MATERIAL</b>	AE:316Ti/AE:TuChne/NPS:C, AE:E/NPS:E	
<b>SPECS</b>	HUHNSEAL, SD: 42mm	
<b>NOTES</b>	--	

<b>VT104 G10</b>	<b>Male Connector Straight G3/8 - T1/4</b>	<b>POS. 1863</b>
<b>PART #</b>	<b>21690</b>	
<b>CUSTOMER REFERENCE #</b>		
<b>MATERIAL</b>	316	
<b>SPECS</b>	G-3/8" x 1/4" Tubing	
<b>NOTES</b>	--	

<b>VT104 G10</b>	<b>Male Connector Straight G3/8 - T3/8</b>	<b>POS. 1864</b>
<b>PART #</b>	<b>21689</b>	
<b>CUSTOMER REFERENCE #</b>		
<b>MATERIAL</b>	316	
<b>SPECS</b>	G-3/8" x 3/8" Tubing	
<b>NOTES</b>	--	

<b>VT104 G10</b>	<b>Seal Housing</b>	<b>POS. 2188</b>
<b>PART #</b>	<b>23611</b>	
<b>CUSTOMER REFERENCE #</b>		
<b>MATERIAL</b>	316L	
<b>SPECS</b>	3A	
<b>NOTES</b>	--	

<b>VT104 G10</b>	<b>Hex Socket Screw for Seal Housing</b>	<b>POS. 2259</b>
<b>PART #</b>	<b>19366</b>	
<b>CUSTOMER REFERENCE #</b>		
<b>MATERIAL</b>	A2-70	
<b>SPECS</b>	DIN912 - M6 x 20mm	
<b>NOTES</b>	--	

<b>VT104 G10</b>	<b>Safety Guard</b>	<b>POS. 2546</b>
<b>PART #</b>	<b>23617</b>	
<b>CUSTOMER REFERENCE #</b>		
<b>MATERIAL</b>	SS	
<b>SPECS</b>	--	
<b>NOTES</b>	--	

**4.3 Bearing Housing**

<b>VT104 G10</b>	<b>Key for Coupling</b>	<b>POS. 1183</b>
<b>PART #</b>	<b>24880</b>	
<b>CUSTOMER REFERENCE #</b>		
<b>MATERIAL</b>	316	
<b>SPECS</b>	DIN6885 - 8 x 7 x 36mm, with M3 thread	
<b>NOTES</b>	--	

<b>VT104 G10</b>	<b>Shaft Sealing Ring Bearing Housing</b>	<b>POS. 2322</b>
<b>PART #</b>	<b>23773</b>	
<b>CUSTOMER REFERENCE #</b>		
<b>MATERIAL</b>	FKM	
<b>SPECS</b>	DIN3760 - AS - 55 x 70 x 8mm	
<b>NOTES</b>	--	

<b>VT104 G10</b>	<b>Dowel Pin for Seal Housing</b>	<b>POS. 2536</b>
<b>PART #</b>	<b>21903</b>	
<b>CUSTOMER REFERENCE #</b>		
<b>MATERIAL</b>	303	
<b>SPECS</b>	DIN7 - 8 h 8 x 24mm, undersize	
<b>NOTES</b>	--	

<b>VT104 G10</b>	<b>Drive Shaft</b>	<b>POS. 1000</b>
<b>PART #</b>	<b>23615</b>	
<b>CUSTOMER REFERENCE #</b>		
<b>MATERIAL</b>	316	
<b>SPECS</b>	Replaceable sleeves	
<b>NOTES</b>	--	

<b>VT104 G10</b>	<b>Shaft Protection Sleeve Gear Housing</b>	<b>POS. 2675</b>
<b>PART #</b>	<b>23400</b>	
<b>CUSTOMER REFERENCE #</b>		
<b>MATERIAL</b>	SS	
<b>SPECS</b>	Hard Inox S treated	
<b>NOTES</b>	--	

<b>VT104 G10</b>	<b>Hex Head Cap Screw for Pump Housing</b>	<b>POS. 1016</b>
<b>PART #</b>	<b>24886</b>	
<b>CUSTOMER REFERENCE #</b>		
<b>MATERIAL</b>	A2-70	
<b>SPECS</b>	M16 - 2 x 80mm	
<b>NOTES</b>	--	

<b>VT104 G10</b>	<b>Hex Head Cap Screw for Gear Housing</b>	<b>POS. 2258</b>
<b>PART #</b>	<b>24887</b>	
<b>CUSTOMER REFERENCE #</b>		
<b>MATERIAL</b>	A2-70	
<b>SPECS</b>	M16 - 2 x 45mm	
<b>NOTES</b>	--	

<b>VT104 G10</b>	<b>O-Ring for Shaft Protection Sleeve Gear Housing</b>	<b>POS. 2676</b>
<b>PART #</b>	<b>23399</b>	
<b>CUSTOMER REFERENCE #</b>		
<b>MATERIAL</b>	FKM	
<b>SPECS</b>	DIN3771 - 25,12 x 1,78mm	
<b>NOTES</b>	--	





<b>VT104 G10</b>	<b>Shaft Protection Sleeve Bearing Housing</b>	<b>POS. 2677</b>
<b>PART #</b>	<b>23705</b>	
<b>CUSTOMER REFERENCE #</b>		
<b>MATERIAL</b>	SS	
<b>SPECS</b>	Hard Inox S treated	
<b>NOTES</b>	--	

<b>VT104 G10</b>	<b>O-Ring for Shaft Protection Sleeve Bearing Housing</b>	<b>POS. 2678</b>
<b>PART #</b>	<b>23704</b>	
<b>CUSTOMER REFERENCE #</b>		
<b>MATERIAL</b>	FKM	
<b>SPECS</b>	ISO3601 - 1, 47.5 x 1,8mm	
<b>NOTES</b>	--	

<b>VT104 G10</b>	<b>Driven Shaft</b>	<b>POS. 2171</b>
<b>PART #</b>	<b>23616</b>	
<b>CUSTOMER REFERENCE #</b>		
<b>MATERIAL</b>	316	
<b>SPECS</b>	Replaceable sleeve	
<b>NOTES</b>	Replaceable sleeve at oil sealing ring positions	

<b>VT104 G10</b>	<b>Bearing Housing</b>	<b>POS. 1001</b>
<b>PART #</b>	<b>23649</b>	
<b>CUSTOMER REFERENCE #</b>		
<b>MATERIAL</b>	Fine Cast 1.4308	
<b>SPECS</b>	--	
<b>NOTES</b>	--	

<b>VT104 G10</b>	<b>Eyebolt</b>	<b>POS. 1001 a</b>
<b>PART #</b>	<b>23579</b>	
<b>CUSTOMER REFERENCE #</b>		
<b>MATERIAL</b>	304	
<b>SPECS</b>	DIN580 - M10mm	
<b>NOTES</b>	--	

<b>VT104 G10</b>	<b>Needle Roller Bearing</b>	<b>POS. 1003</b>
<b>PART #</b>	<b>23503</b>	
<b>CUSTOMER REFERENCE #</b>		
<b>MATERIAL</b>	--	
<b>SPECS</b>	--	
<b>NOTES</b>	--	

<b>VT104 G10</b>	<b>Lock Snap Ring</b>	<b>POS. 1009 a, b</b>
<b>PART #</b>	<b>19316</b>	
<b>CUSTOMER REFERENCE #</b>		
<b>MATERIAL</b>	--	
<b>SPECS</b>	--	
<b>NOTES</b>	--	

<b>VT104 G10</b>	<b>Outer Spacer Ring for Ball Bearing</b>	<b>POS. 1121</b>
<b>PART #</b>	<b>12539</b>	
<b>CUSTOMER REFERENCE #</b>		
<b>MATERIAL</b>	SS	
<b>SPECS</b>	outside	
<b>NOTES</b>	--	

<b>VT104 G10</b>	<b>Inner Spacer Ring for Ball Bearing</b>	<b>POS. 1530</b>
<b>PART #</b>	<b>12540</b>	
<b>CUSTOMER REFERENCE #</b>		
<b>MATERIAL</b>	SS	
<b>SPECS</b>	inside	
<b>NOTES</b>	--	

<b>VT104 G10</b>	<b>Spacer Sleeve for Bearings</b>	<b>POS. 1529</b>
<b>PART #</b>	<b>23610</b>	
<b>CUSTOMER REFERENCE #</b>		
<b>MATERIAL</b>	304	
<b>SPECS</b>	--	
<b>NOTES</b>	--	

<b>VT104 G10</b>	<b>Angular Ball Bearing</b>	<b>POS. 2181</b>
<b>PART #</b>	<b>21963</b>	
<b>CUSTOMER REFERENCE #</b>		
<b>MATERIAL</b>	--	
<b>SPECS</b>	--	
<b>NOTES</b>	--	

<b>VT104 G10</b>	<b>Key for Gear Wheel</b>	<b>POS. 2179</b>
<b>PART #</b>	<b>22256</b>	
<b>CUSTOMER REFERENCE #</b>		
<b>MATERIAL</b>	SS	
<b>SPECS</b>	DIN6885 - AS - 10 x 8 x 32mm	
<b>NOTES</b>	--	

<b>VT104 G10</b>	<b>Venting Valve</b>	<b>POS. 2232</b>
<b>PART #</b>	<b>23563</b>	
<b>CUSTOMER REFERENCE #</b>		
<b>MATERIAL</b>	304	
<b>SPECS</b>	M12 - 1,5mm	
<b>NOTES</b>	--	

**4.4 Gear Housing**

<b>VT104 G10</b>	<b>Shaft Sealing Ring Gear Housing</b>	<b>POS. 1010</b>
<b>PART #</b>	<b>21905</b>	
<b>CUSTOMER REFERENCE #</b>		
<b>MATERIAL</b>	FKM	
<b>SPECS</b>	SD:45mm	
<b>NOTES</b>	--	

<b>VT104 G10</b>	<b>Magnetic Screw Plug</b>	<b>POS. 2233</b>
<b>PART #</b>	<b>21767</b>	
<b>CUSTOMER REFERENCE #</b>		
<b>MATERIAL</b>	Aluminium	
<b>SPECS</b>	3/4"	
<b>NOTES</b>	--	



<b>VT104 G10</b>	<b>Gasket for Magnetic Screw Plug</b>	<b>POS. 2233 a</b>
<b>PART #</b>	<b>23114</b>	
<b>CUSTOMER REFERENCE #</b>		
<b>MATERIAL</b>	FKM	
<b>SPECS</b>	Gasket for Magnetic Screw Plug	
<b>NOTES</b>	In set of 5 only	

<b>VT104 G10</b>	<b>Oil Level Sight Gauge</b>	<b>POS. 2360</b>
<b>PART #</b>	<b>21766</b>	
<b>CUSTOMER REFERENCE #</b>		
<b>MATERIAL</b>	--	
<b>SPECS</b>	G3/4"	
<b>NOTES</b>	--	

<b>VT104 G10</b>	<b>Gasket for Oil Level Sight Gauge</b>	<b>POS. 2360 a</b>
<b>PART #</b>	<b>23665</b>	
<b>CUSTOMER REFERENCE #</b>		
<b>MATERIAL</b>	FKM	
<b>SPECS</b>	Gasket for Oil Level Sight Gauge	
<b>NOTES</b>	In set of 5 only	

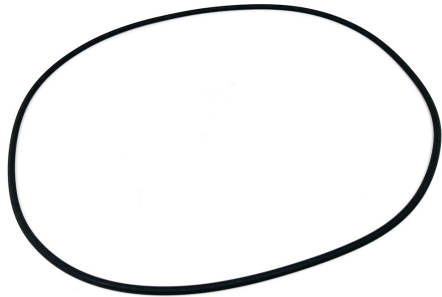
<b>VT104 G10</b>	<b>O-Ring Large for Gear Housing</b>	<b>POS. 2513</b>
<b>PART #</b>	<b>21764</b>	
<b>CUSTOMER REFERENCE #</b>		
<b>MATERIAL</b>	FKM	
<b>SPECS</b>	DIN3771 - 237 x 4mm	
<b>NOTES</b>	--	

<b>VT104 G10</b>	<b>O-Ring Small for Gear Housing</b>	<b>POS. 2514</b>
<b>PART #</b>	<b>21765</b>	
<b>CUSTOMER REFERENCE #</b>		
<b>MATERIAL</b>	FKM	
<b>SPECS</b>	DIN3771 - 18,5 x 2mm	
<b>NOTES</b>	--	

<b>VT104 G10</b>	<b>Gear Oil Bearing Housing VT</b>	<b>POS. --</b>
<b>PART #</b>	<b>21871</b>	
<b>CUSTOMER REFERENCE #</b>		
<b>MATERIAL</b>	--	
<b>SPECS</b>	1 L, foodgrade	
<b>NOTES</b>	--	

<b>VT104 G10</b>	<b>Oil Sample Test Kit</b>	<b>POS. --</b>
<b>PART #</b>	<b>23580</b>	
<b>CUSTOMER REFERENCE #</b>		
<b>MATERIAL</b>	--	
<b>SPECS</b>	--	
<b>NOTES</b>	--	

<b>VT104 G10</b>	<b>Hex Socket Screw for Bearing Cover</b>	<b>POS. 1008</b>
<b>PART #</b>	<b>19341</b>	
<b>CUSTOMER REFERENCE #</b>		
<b>MATERIAL</b>	Steel 10.9	
<b>SPECS</b>	DIN6912 - M8 x 25mm, B=22mm, Low profile socket head	
<b>NOTES</b>	--	

<b>VT104 G10</b>	<b>Bearing Cover</b>	<b>POS. 1227</b>
<b>PART #</b>	<b>19096</b>	
<b>CUSTOMER REFERENCE #</b>		
<b>MATERIAL</b>	C45	
<b>SPECS</b>	--	
<b>NOTES</b>	--	

<b>VT104 G10</b>	<b>Gear Wheel Nut for Drive Shaft</b>	<b>POS. 1526</b>
<b>PART #</b>	<b>19320</b>	
<b>CUSTOMER REFERENCE #</b>		
<b>MATERIAL</b>	SS	
<b>SPECS</b>	--	
<b>NOTES</b>	--	

<b>VT104 G10</b>	<b>Gear Housing Right</b>	<b>POS. 2172</b>
<b>PART #</b>	<b>23648</b>	
<b>CUSTOMER REFERENCE #</b>		
<b>MATERIAL</b>	Fine Cast 1.4308	
<b>SPECS</b>	Right, Housing with gapping port	
<b>NOTES</b>	--	

<b>VT104 G10</b>	<b>Gear Housing Left</b>	<b>POS. 2172</b>
<b>PART #</b>	<b>23647</b>	
<b>CUSTOMER REFERENCE #</b>		
<b>MATERIAL</b>	Fine Cast 1.4308	
<b>SPECS</b>	Left, Housing with gapping port	
<b>NOTES</b>	--	

<b>VT104 G10</b>	<b>Gapping Port Plug</b>	<b>POS. 3100</b>
<b>PART #</b>	<b>23508</b>	
<b>CUSTOMER REFERENCE #</b>		
<b>MATERIAL</b>	304	
<b>SPECS</b>	50mm	
<b>NOTES</b>	--	

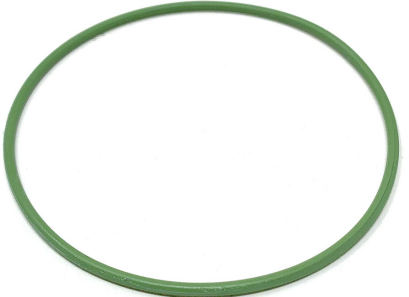
<b>VT104 G10</b>	<b>O-Ring for Gapping Port Plug</b>	<b>POS. 3100 a</b>
<b>PART #</b>	<b>23650</b>	
<b>CUSTOMER REFERENCE #</b>		
<b>MATERIAL</b>	FKM	
<b>SPECS</b>	--	
<b>NOTES</b>	--	

<b>VT104 G10</b>	<b>Gear Wheel Collar Driven Shaft</b>	<b>POS. 2176</b>
<b>PART #</b>	<b>22420</b>	
<b>CUSTOMER REFERENCE #</b>		
<b>MATERIAL</b>	304	
<b>SPECS</b>	--	
<b>NOTES</b>	--	

<b>VT104 G10</b>	<b>Hex Bolt for Driven Shaft</b>	<b>POS. 2177</b>
<b>PART #</b>	<b>22335</b>	
<b>CUSTOMER REFERENCE #</b>		
<b>MATERIAL</b>	Steel 12.9	
<b>SPECS</b>	ISO4017 - M16 x 50mm	
<b>NOTES</b>	--	



<b>VT104 G10</b>	<b>Press Ring Gear Wheel Driven Shaft</b>	<b>POS. 2178</b>
<b>PART #</b>	<b>22436</b>	
<b>CUSTOMER REFERENCE #</b>		
<b>MATERIAL</b>	SS/304	
<b>SPECS</b>	--	
<b>NOTES</b>	--	

<b>VT104 G10</b>	<b>Gear Wheel Drive Shaft</b>	<b>POS. 2183</b>
<b>PART #</b>	<b>22337</b>	
<b>CUSTOMER REFERENCE #</b>		
<b>MATERIAL</b>	AISI 5115, hardened	
<b>SPECS</b>	58teeth, w=20mm, module 1,5	
<b>NOTES</b>	--	

<b>VT104 G10</b>	<b>Gear Wheel Driven Shaft</b>	<b>POS. 2184</b>
<b>PART #</b>	<b>22338</b>	
<b>CUSTOMER REFERENCE #</b>		
<b>MATERIAL</b>	AISI 5115, hardened	
<b>SPECS</b>	49 teeth, b:20mm, module 1,5	
<b>NOTES</b>	--	

<b>VT104 G10</b>	<b>Hex Socket Screw for Gear Synchronization Lock Ring</b>	<b>POS. 2186</b>
<b>PART #</b>	<b>22332</b>	
<b>CUSTOMER REFERENCE #</b>		
<b>MATERIAL</b>	Steel 12.9	
<b>SPECS</b>	ISO4762 - M6 - 1 x 25mm	
<b>NOTES</b>	--	

<b>VT104 G10</b>	<b>Dowel Pin for Gear Housing</b>	<b>POS. 2256</b>
<b>PART #</b>	<b>18764</b>	
<b>CUSTOMER REFERENCE #</b>		
<b>MATERIAL</b>	303	
<b>SPECS</b>	DIN7 - 8m6 x 20mm, undersize	
<b>NOTES</b>	--	

<b>VT104 G10</b>	<b>Gear Synchronization Lock Ring</b>	<b>POS. 2515</b>
<b>PART #</b>	<b>22027</b>	
<b>CUSTOMER REFERENCE #</b>		
<b>MATERIAL</b>	304	
<b>SPECS</b>	--	
<b>NOTES</b>	--	