

SPARE PARTS

ViscoTwin

VT104

G10, V1

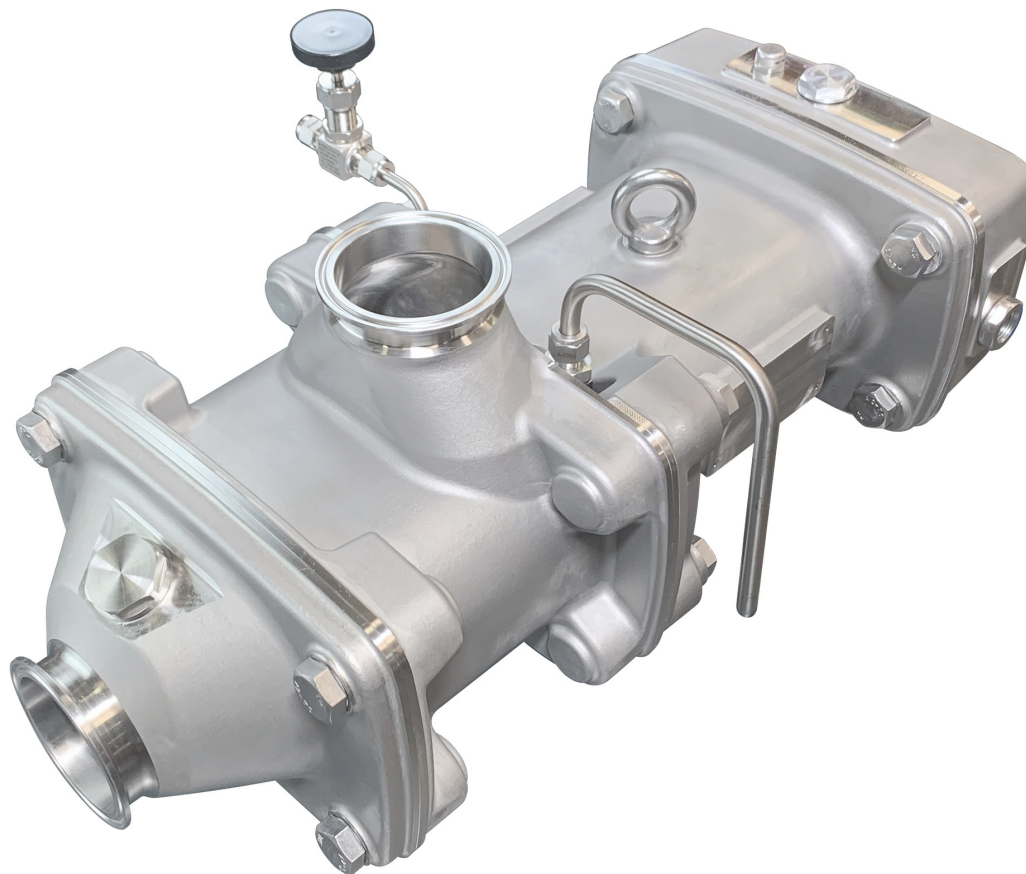

GET TOMORROW'S TECHNOLOGY TODAY

processtec.com
info@processtec.com

9938 W Legacy Ave
Visalia, CA 93291
Phone +1 (559) 429 - 4227
Fax +1 (559) 429 - 4228

1. OVERVIEW DRAWING 3

2. EXPLOSION DRAWING 4

3. TORQUE VALUES. 5

4. SPARE PARTS. 6

4.1 Pump Housing. 6

4.2 Seal Housing 15

4.3 Bearing Housing 21

4.4 Gear Housing. 32

1. OVERVIEW DRAWING

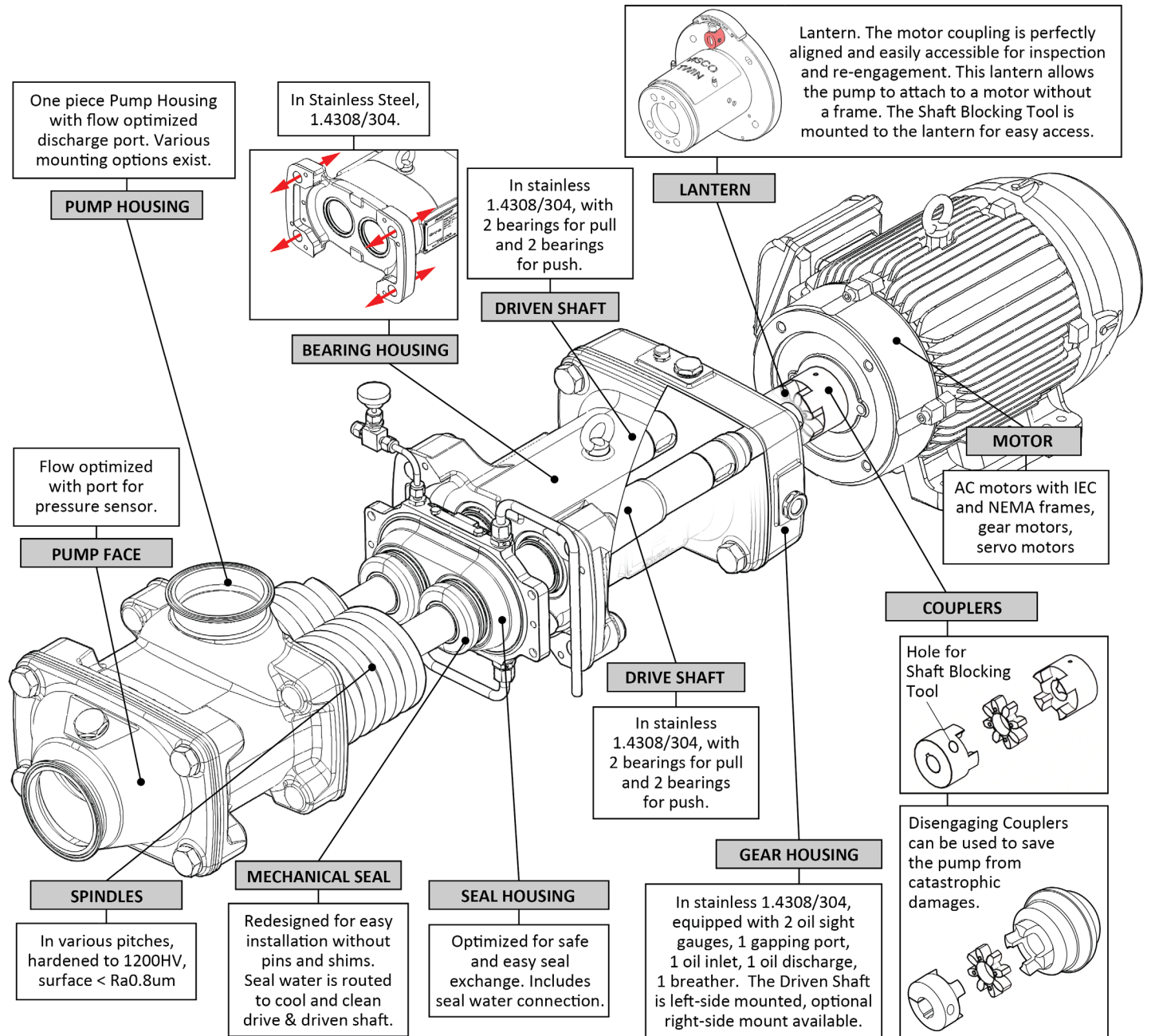

2. EXPLOSION DRAWING

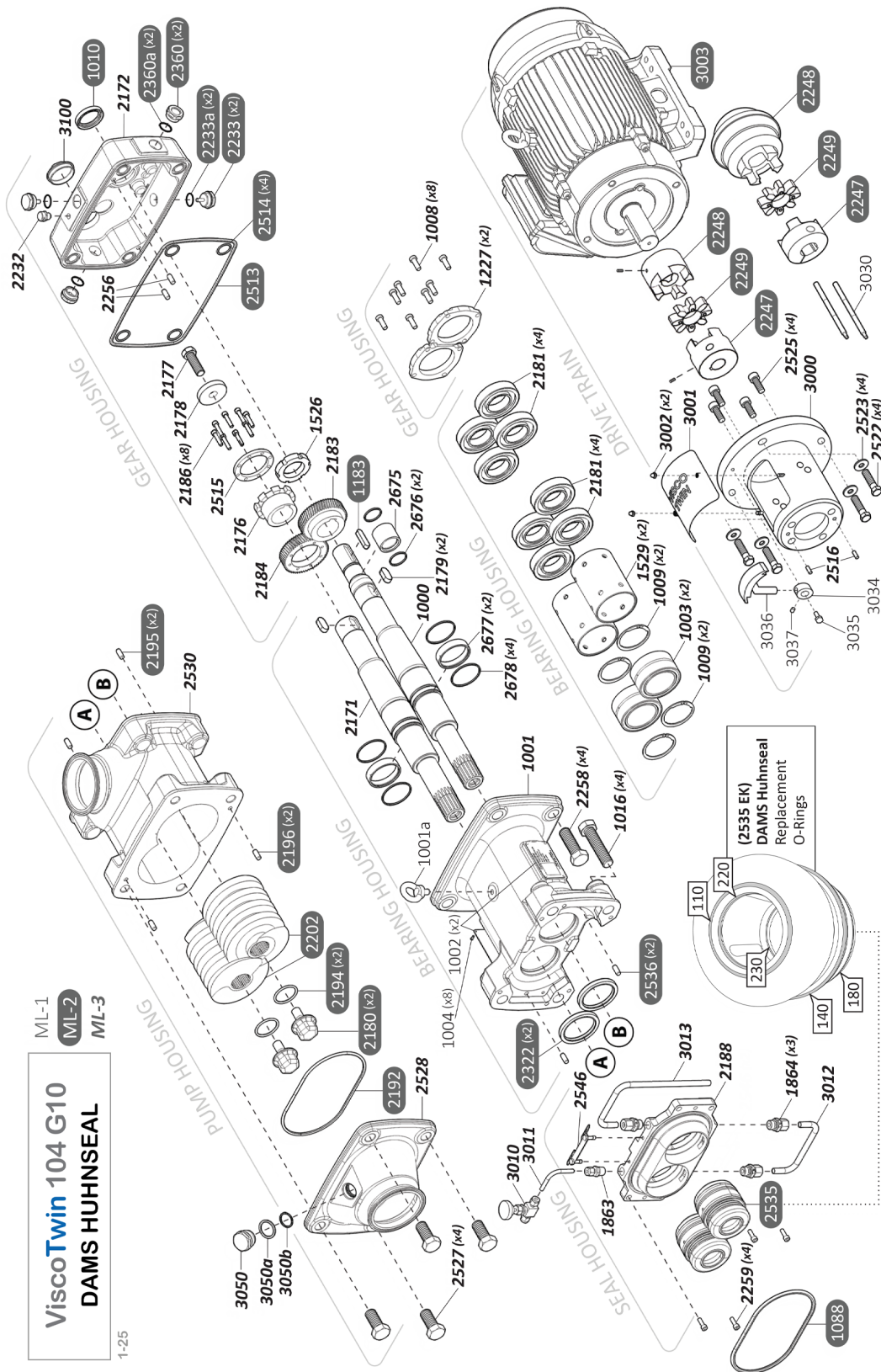

3. TORQUE VALUES

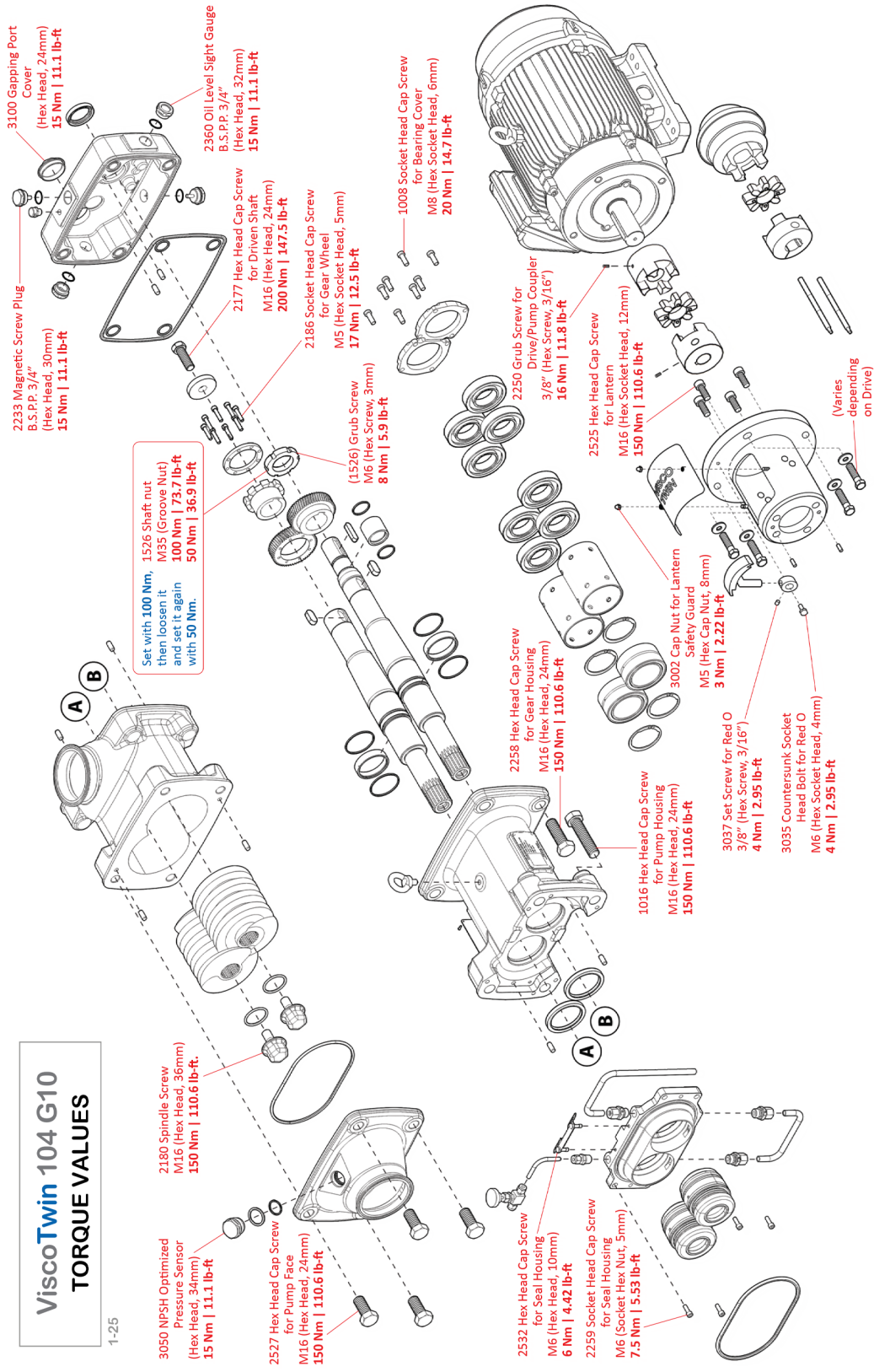



4. SPARE PARTS

4.1 Pump Housing

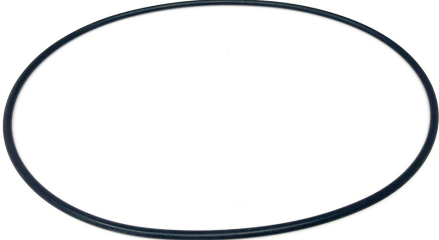
VT104 G10	Spindle Bolt	POS. 2180
PART #	23113	
CUSTOMER REFERENCE #		
MATERIAL	2205	
SPECS	Hex Style	
NOTES	--	

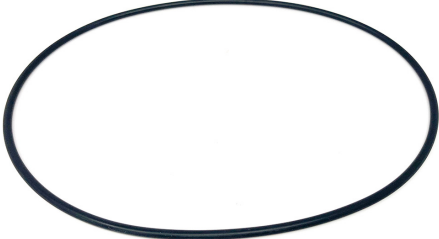
VT104 G10	O-Ring for Pump Face	POS. 2192
PART #	12505	
CUSTOMER REFERENCE #		
MATERIAL	FKM	
SPECS	155 x 4mm	
NOTES	--	

VT104 G10	O-Ring for Pump Face	POS. 2192
PART #	12511	
CUSTOMER REFERENCE #		
MATERIAL	EPDM	
SPECS	155 x 4mm	
NOTES	--	

VT104 G10	O-Ring for Spindle Bolt	POS. 2194
PART #	12504	
CUSTOMER REFERENCE #		
MATERIAL	FKM	
SPECS	42 x 3mm	
NOTES	--	

VT104 G10	O-Ring for Spindle Bolt	POS. 2194
PART #	12510	
CUSTOMER REFERENCE #		
MATERIAL	EPDM	
SPECS	42 x 3mm	
NOTES	--	

VT104 G10	Dowel Pin for Pump Face & Housing	POS. 2195, 2196
PART #	12616	
CUSTOMER REFERENCE #		
MATERIAL	303	
SPECS	DIN7 - 8 h 8 x 20mm, undersize	
NOTES	--	

VT104 G10	Spindle Pair VT104.27	POS. 2202
PART #	12639	
CUSTOMER REFERENCE #		
MATERIAL	316L	
SPECS	27mm, hardened	
NOTES		

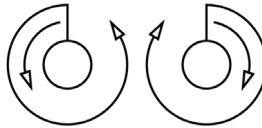
VT104 G10	Spindle Pair VT104.36	POS. 2202
PART #	18489	
CUSTOMER REFERENCE #		
MATERIAL	316L	
SPECS	36mm, hardened	
NOTES		

VT104 G10	Spindle Pair VT104.53	POS. 2202
PART #	17516	
CUSTOMER REFERENCE #		
MATERIAL	316L	
SPECS	53mm, hardened	
NOTES		

VT104 G10	Hex Head Cap Screw for Pump Face	POS. 2527
PART #	24888	
CUSTOMER REFERENCE #		
MATERIAL	A2-70	
SPECS	M16 - 2 x 45mm	
NOTES	--	

VT104 G10	Pump Face OD3"	POS. 2528
PART #	23645	
CUSTOMER REFERENCE #		
MATERIAL	PF:FC316	
SPECS	PF:OD3", Tri-Clamp	
NOTES	With Gauge Port	

VT104 G10	Pump Face OD4"	POS. 2528
PART #	23646	
CUSTOMER REFERENCE #		
MATERIAL	PF:FC316L	
SPECS	PF:OD4", Tri-Clamp	
NOTES	With Gauge Port	

VT104 G10	Pump Housing OD2-1/2"	POS. 2530
PART #	23680	
CUSTOMER REFERENCE #		
MATERIAL	FC316L	
SPECS	PCP:OD2-1/2" Tri-Clamp	
NOTES	--	

VT104 G10	Pump Housing OD3"	POS. 2530
PART #	23644	
CUSTOMER REFERENCE #		
MATERIAL	FC316L	
SPECS	PCP: OD3", Tri-Clamp	
NOTES	--	

VT104 G10	Aseptoflex Plug for Sensor Port	POS. 3050
PART #	22252	
CUSTOMER REFERENCE #		
MATERIAL	316L	
SPECS	--	
NOTES	--	

VT104 G10	Gasket for Aseptoflex Plug (green)	POS. 3050 a
PART #	22948	
CUSTOMER REFERENCE #		
MATERIAL	FKM	
SPECS	ID: 29.7mm x OD: 35.7mm	
NOTES	--	

VT104 G10	O-Ring for Aseptoflex Plug	POS. 3050 b
PART #	22253	
CUSTOMER REFERENCE #		
MATERIAL	FKM	
SPECS	O-ring: 24 x 2mm (FKM), in contact with the medium	
NOTES	--	

4.2 Seal Housing

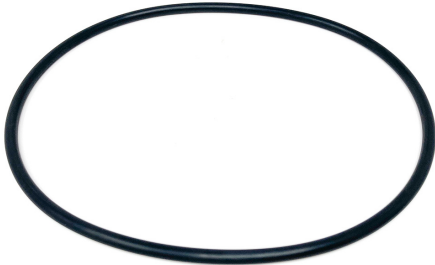
VT104 G10	O-Ring Seal Housing	POS. 1088
PART #	12503	
CUSTOMER REFERENCE #		
MATERIAL	FKM	
SPECS	142 x 6.2mm	
NOTES	--	

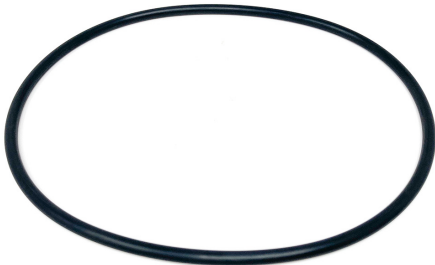
VT104 G10	O-Ring Seal Housing	POS. 1088
PART #	12512	
CUSTOMER REFERENCE #		
MATERIAL	EPDM	
SPECS	142 x 6.2mm	
NOTES	--	

VT104 G10	Elastomer Kit DAMS	POS. 2535 EK
PART #	24918	
CUSTOMER REFERENCE #		
MATERIAL	FKM	
SPECS	HUHNSEAL, SD: 42mm	
NOTES	--	

VT104 G10	Mechanical Seal DAMS	POS. 2535
PART #	23673	
CUSTOMER REFERENCE #		
MATERIAL	AE:316Ti/AE:SiC/NPS:C, NPS:E/AE:FKM	
SPECS	HUHNSEAL, SD: 42mm	
NOTES	--	

VT104 G10	Mechanical Seal DAMS	POS. 2535
PART #	23850	
CUSTOMER REFERENCE #		
MATERIAL	AE:316Ti/AE:SiC/NPS:C, AE:E/NPS:E	
SPECS	HUHNSEAL, SD: 42mm	
NOTES	--	

VT104 G10	Mechanical Seal DAMS	POS. 2535
PART #	23555	
CUSTOMER REFERENCE #		
MATERIAL	AE:316Ti/AE:TuCkne/AE:TuC, NPS:E/AE:FKM	
SPECS	HUHNSEAL, SD: 42mm	
NOTES	--	

VT104 G10	Mechanical Seal DAMS	POS. 2535
PART #	21566	
CUSTOMER REFERENCE #		
MATERIAL	AE:316Ti/AE:TuCkne/NPS:C, AE:E/NPS:E	
SPECS	HUHNSEAL, SD: 42mm	
NOTES	--	

VT104 G10	Male Connector Straight G3/8 - T1/4	POS. 1863
PART #	21690	
CUSTOMER REFERENCE #		
MATERIAL	316	
SPECS	G-3/8" x 1/4" Tubing	
NOTES	--	

VT104 G10	Male Connector Straight G3/8 - T3/8	POS. 1864
PART #	21689	
CUSTOMER REFERENCE #		
MATERIAL	316	
SPECS	G-3/8" x 3/8" Tubing	
NOTES	--	

VT104 G10	Seal Housing	POS. 2188
PART #	23611	
CUSTOMER REFERENCE #		
MATERIAL	316L	
SPECS	3A	
NOTES	--	

VT104 G10	Hex Socket Screw for Seal Housing	POS. 2259
PART #	19366	
CUSTOMER REFERENCE #		
MATERIAL	A2-70	
SPECS	DIN912 - M6 x 20mm	
NOTES	--	

VT104 G10	Safety Guard	POS. 2546
PART #	23617	
CUSTOMER REFERENCE #		
MATERIAL	SS	
SPECS	--	
NOTES	--	

4.3 Bearing Housing

VT104 G10	Key for Coupling	POS. 1183
PART #	24880	
CUSTOMER REFERENCE #		
MATERIAL	316	
SPECS	DIN6885 - 8 x 7 x 36mm, with M3 thread	
NOTES	--	

VT104 G10	Shaft Sealing Ring Bearing Housing	POS. 2322
PART #	23773	
CUSTOMER REFERENCE #		
MATERIAL	FKM	
SPECS	DIN3760 - AS - 55 x 70 x 8mm	
NOTES	--	

VT104 G10	Dowel Pin for Seal Housing	POS. 2536
PART #	21903	
CUSTOMER REFERENCE #		
MATERIAL	303	
SPECS	DIN7 - 8 h 8 x 24mm, undersize	
NOTES	--	

VT104 G10	Drive Shaft	POS. 1000
PART #	23615	
CUSTOMER REFERENCE #		
MATERIAL	316	
SPECS	Replaceable sleeves	
NOTES	--	

VT104 G10	Shaft Protection Sleeve Gear Housing	POS. 2675
PART #	23400	
CUSTOMER REFERENCE #		
MATERIAL	SS	
SPECS	Hard Inox S treated	
NOTES	--	

VT104 G10	Hex Head Cap Screw for Pump Housing	POS. 1016
PART #	24886	
CUSTOMER REFERENCE #		
MATERIAL	A2-70	
SPECS	M16 - 2 x 80mm	
NOTES	--	

VT104 G10	Hex Head Cap Screw for Gear Housing	POS. 2258
PART #	24887	
CUSTOMER REFERENCE #		
MATERIAL	A2-70	
SPECS	M16 - 2 x 45mm	
NOTES	--	

VT104 G10	O-Ring for Shaft Protection Sleeve Gear Housing	POS. 2676
PART #	23399	
CUSTOMER REFERENCE #		
MATERIAL	FKM	
SPECS	DIN3771 - 25,12 x 1,78mm	
NOTES	--	

VT104 G10	Shaft Protection Sleeve Bearing Housing	POS. 2677
PART #	23705	
CUSTOMER REFERENCE #		
MATERIAL	SS	
SPECS	Hard Inox S treated	
NOTES	--	

VT104 G10	O-Ring for Shaft Protection Sleeve Bearing Housing	POS. 2678
PART #	23704	
CUSTOMER REFERENCE #		
MATERIAL	FKM	
SPECS	ISO3601 - 1, 47.5 x 1,8mm	
NOTES	--	

VT104 G10	Driven Shaft	POS. 2171
PART #	23616	
CUSTOMER REFERENCE #		
MATERIAL	316	
SPECS	Replaceable sleeve	
NOTES	Replaceable sleeve at oil sealing ring positions	

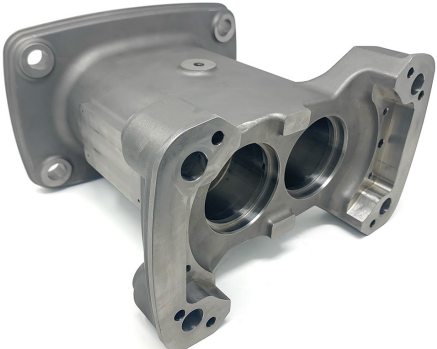
VT104 G10	Bearing Housing	POS. 1001
PART #	23649	
CUSTOMER REFERENCE #		
MATERIAL	Fine Cast 1.4308	
SPECS	--	
NOTES	--	

VT104 G10	Eyebolt	POS. 1001 a
PART #	23579	
CUSTOMER REFERENCE #		
MATERIAL	304	
SPECS	DIN580 - M10mm	
NOTES	--	

VT104 G10	Needle Roller Bearing	POS. 1003
PART #	23503	
CUSTOMER REFERENCE #		
MATERIAL	--	
SPECS	--	
NOTES	--	

VT104 G10	Lock Snap Ring	POS. 1009 a, b
PART #	19316	
CUSTOMER REFERENCE #		
MATERIAL	--	
SPECS	--	
NOTES	--	

VT104 G10	Outer Spacer Ring for Ball Bearing	POS. 1121
PART #	12539	
CUSTOMER REFERENCE #		
MATERIAL	SS	
SPECS	outside	
NOTES	--	

VT104 G10	Inner Spacer Ring for Ball Bearing	POS. 1530
PART #	12540	
CUSTOMER REFERENCE #		
MATERIAL	SS	
SPECS	inside	
NOTES	--	

VT104 G10	Spacer Sleeve for Bearings	POS. 1529
PART #	23610	
CUSTOMER REFERENCE #		
MATERIAL	304	
SPECS	--	
NOTES	--	

VT104 G10	Angular Ball Bearing	POS. 2181
PART #	21963	
CUSTOMER REFERENCE #		
MATERIAL	--	
SPECS	--	
NOTES	--	

VT104 G10	Key for Gear Wheel	POS. 2179
PART #	22256	
CUSTOMER REFERENCE #		
MATERIAL	SS	
SPECS	DIN6885 - AS - 10 x 8 x 32mm	
NOTES	--	

VT104 G10	Venting Valve	POS. 2232
PART #	23563	
CUSTOMER REFERENCE #		
MATERIAL	304	
SPECS	M12 - 1,5mm	
NOTES	--	

4.4 Gear Housing

VT104 G10	Shaft Sealing Ring Gear Housing	POS. 1010
PART #	21905	
CUSTOMER REFERENCE #		
MATERIAL	FKM	
SPECS	SD:45mm	
NOTES	--	

VT104 G10	Magnetic Screw Plug	POS. 2233
PART #	21767	
CUSTOMER REFERENCE #		
MATERIAL	Aluminium	
SPECS	3/4"	
NOTES	--	

VT104 G10	Gasket for Magnetic Screw Plug	POS. 2233 a
PART #	23114	
CUSTOMER REFERENCE #		
MATERIAL	FKM	
SPECS	Gasket for Magnetic Screw Plug	
NOTES	In set of 5 only	

VT104 G10	Oil Level Sight Gauge	POS. 2360
PART #	21766	
CUSTOMER REFERENCE #		
MATERIAL	--	
SPECS	G3/4"	
NOTES	--	

VT104 G10	Gasket for Oil Level Sight Gauge	POS. 2360 a
PART #	23665	
CUSTOMER REFERENCE #		
MATERIAL	FKM	
SPECS	Gasket for Oil Level Sight Gauge	
NOTES	In set of 5 only	

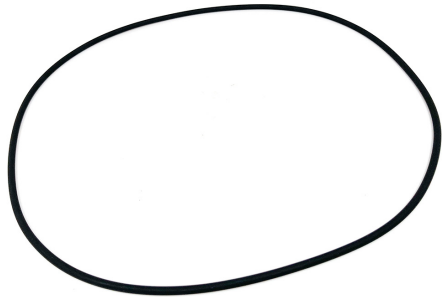
VT104 G10	O-Ring Large for Gear Housing	POS. 2513
PART #	21764	
CUSTOMER REFERENCE #		
MATERIAL	FKM	
SPECS	DIN3771 - 237 x 4mm	
NOTES	--	

VT104 G10	O-Ring Small for Gear Housing	POS. 2514
PART #	21765	
CUSTOMER REFERENCE #		
MATERIAL	FKM	
SPECS	DIN3771 - 18,5 x 2mm	
NOTES	--	

VT104 G10	Gear Oil Bearing Housing VT	POS. 2170
PART #	21871	
CUSTOMER REFERENCE #		
MATERIAL	--	
SPECS	1 L, foodgrade	
NOTES	--	

VT104 G10	Oil Sample Test Kit	POS. 2173
PART #	23580	
CUSTOMER REFERENCE #		
MATERIAL	--	
SPECS	--	
NOTES	--	

VT104 G10	Hex Socket Screw for Bearing Cover	POS. 1008
PART #	19341	
CUSTOMER REFERENCE #		
MATERIAL	Steel 10.9	
SPECS	DIN6912 - M8 x 25mm, B=22mm, Low profile socket head	
NOTES	--	

VT104 G10	Bearing Cover	POS. 1227
PART #	19096	
CUSTOMER REFERENCE #		
MATERIAL	C45	
SPECS	--	
NOTES	--	

VT104 G10	Gear Wheel Nut for Drive Shaft	POS. 1526
PART #	19320	
CUSTOMER REFERENCE #		
MATERIAL	SS	
SPECS	--	
NOTES	--	

VT104 G10	Gear Housing Right	POS. 2172
PART #	23648	
CUSTOMER REFERENCE #		
MATERIAL	Fine Cast 1.4308	
SPECS	Right, Housing with gapping port	
NOTES	--	

VT104 G10	Gear Housing Left	POS. 2172
PART #	23647	
CUSTOMER REFERENCE #		
MATERIAL	Fine Cast 1.4308	
SPECS	Left, Housing with gapping port	
NOTES	--	

VT104 G10	Gapping Port Plug	POS. 3100
PART #	23508	
CUSTOMER REFERENCE #		
MATERIAL	304	
SPECS	50mm	
NOTES	--	

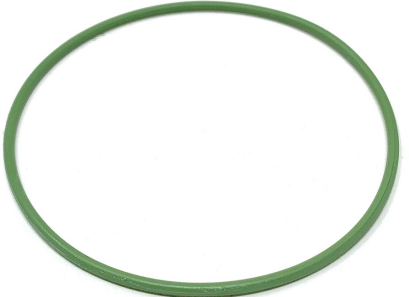
VT104 G10	O-Ring for Gapping Port Plug	POS. 3100 a
PART #	23650	
CUSTOMER REFERENCE #		
MATERIAL	FKM	
SPECS	--	
NOTES	--	

VT104 G10	Gear Wheel Collar Driven Shaft	POS. 2176
PART #	22420	
CUSTOMER REFERENCE #		
MATERIAL	304	
SPECS	--	
NOTES	--	

VT104 G10	Hex Bolt for Driven Shaft	POS. 2177
PART #	22335	
CUSTOMER REFERENCE #		
MATERIAL	Steel 12.9	
SPECS	ISO4017 - M16 x 50mm	
NOTES	--	

VT104 G10	Press Ring Gear Wheel Driven Shaft	POS. 2178
PART #	22436	
CUSTOMER REFERENCE #		
MATERIAL	SS/304	
SPECS	--	
NOTES	--	

VT104 G10	Gear Wheel Drive Shaft	POS. 2183
PART #	22337	
CUSTOMER REFERENCE #		
MATERIAL	AISI 5115, hardened	
SPECS	58teeth, w=20mm, module 1,5	
NOTES	--	

VT104 G10	Gear Wheel Driven Shaft	POS. 2184
PART #	22338	
CUSTOMER REFERENCE #		
MATERIAL	AISI 5115, hardened	
SPECS	49 teeth, b:20mm, module 1,5	
NOTES	--	

VT104 G10	Hex Socket Screw for Gear Synchronization Lock Ring	POS. 2186
PART #	22332	
CUSTOMER REFERENCE #		
MATERIAL	Steel 12.9	
SPECS	ISO4762 - M6 - 1 x 25mm	
NOTES	--	

VT104 G10	Dowel Pin for Gear Housing	POS. 2256
PART #	18764	
CUSTOMER REFERENCE #		
MATERIAL	303	
SPECS	DIN7 - 8m6 x 20mm, undersize	
NOTES	--	

VT104 G10	Gear Synchronization Lock Ring	POS. 2515
PART #	22027	
CUSTOMER REFERENCE #		
MATERIAL	304	
SPECS	--	
NOTES	--	