

SPARE PARTS

ViscoTwin

VT70

G10, V1

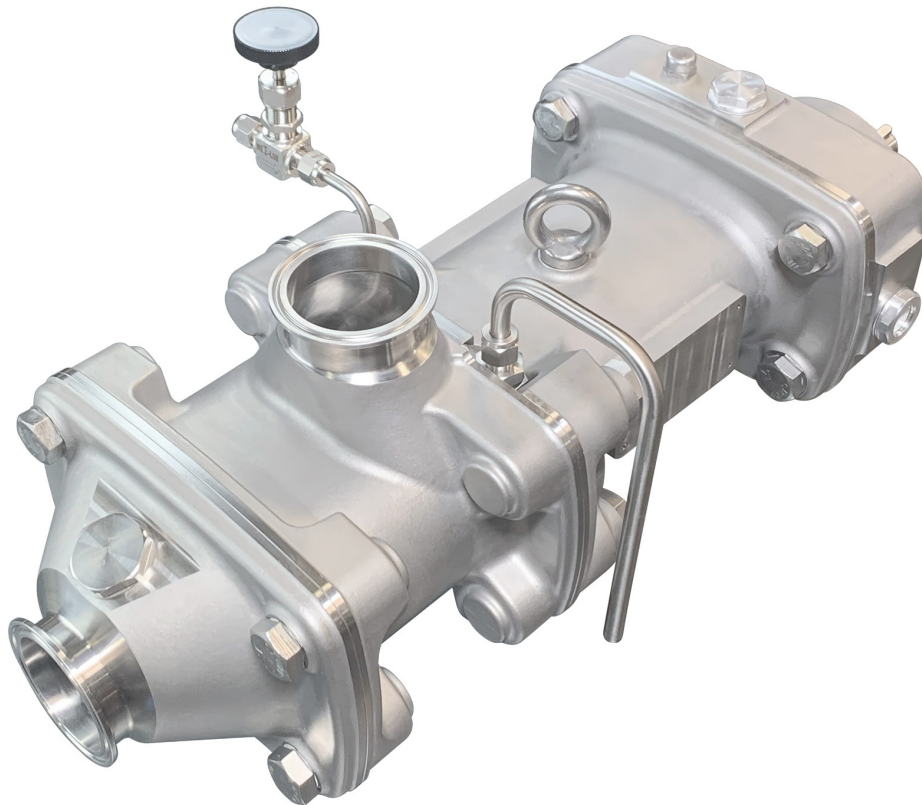

**PROCESSTEC**
GET TOMORROW'S TECHNOLOGY TODAY

processtec.com
info@processtec.com

9938 W Legacy Ave
Visalia, CA 93291
Phone +1 (559) 429 - 4227
Fax +1 (559) 429 - 4228

1. OVERVIEW DRAWING 3

2. EXPLOSION DRAWING 4

3. TORQUE VALUES. 5

4. SPARE PARTS. 6

4.1 Pump Housing. 6

4.2 Seal Housing 15

4.3 Bearing Housing 20

4.4 Gear Housing. 30

1. OVERVIEW DRAWING

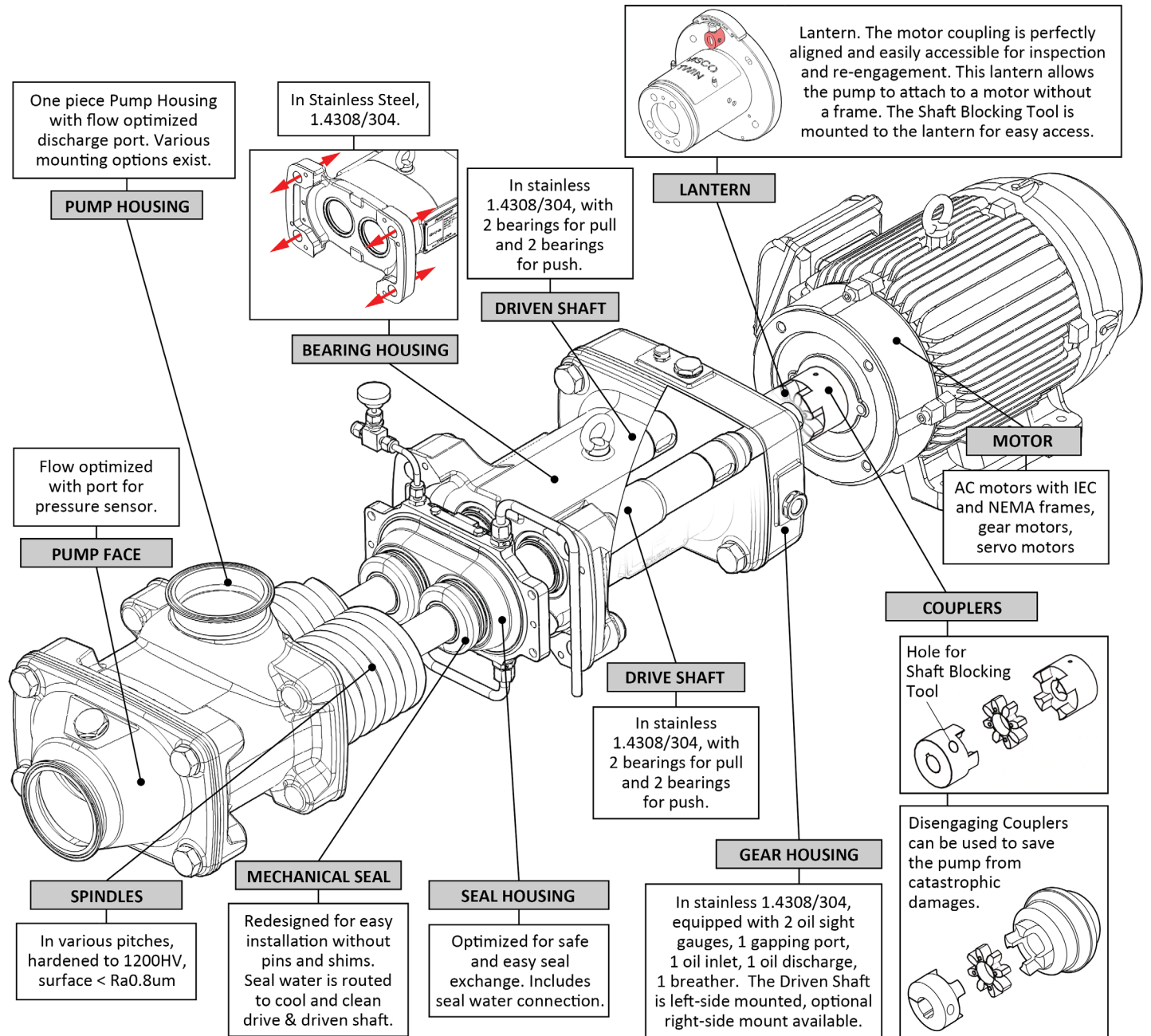

2. EXPLOSION DRAWING

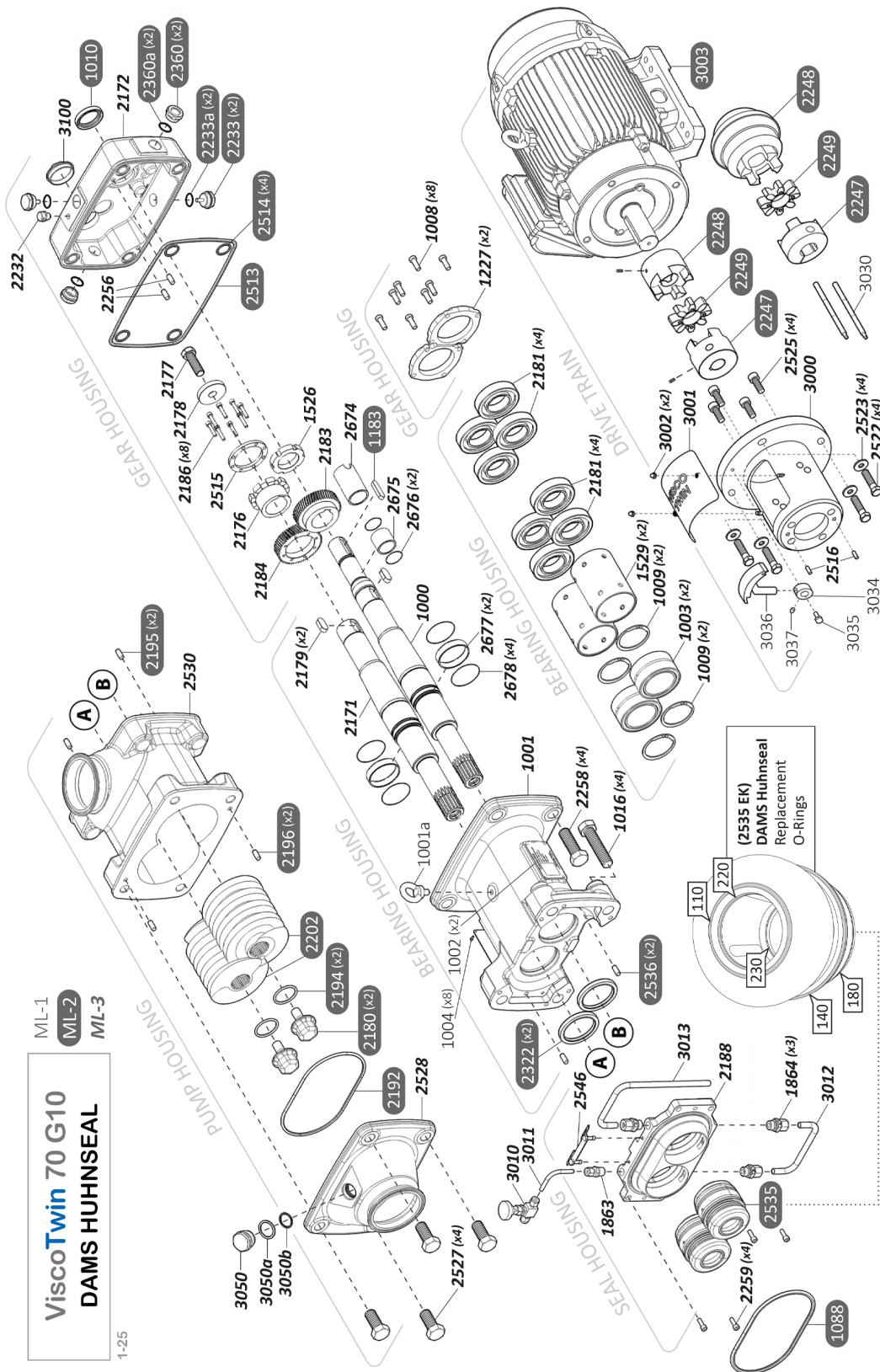

3. TORQUE VALUES

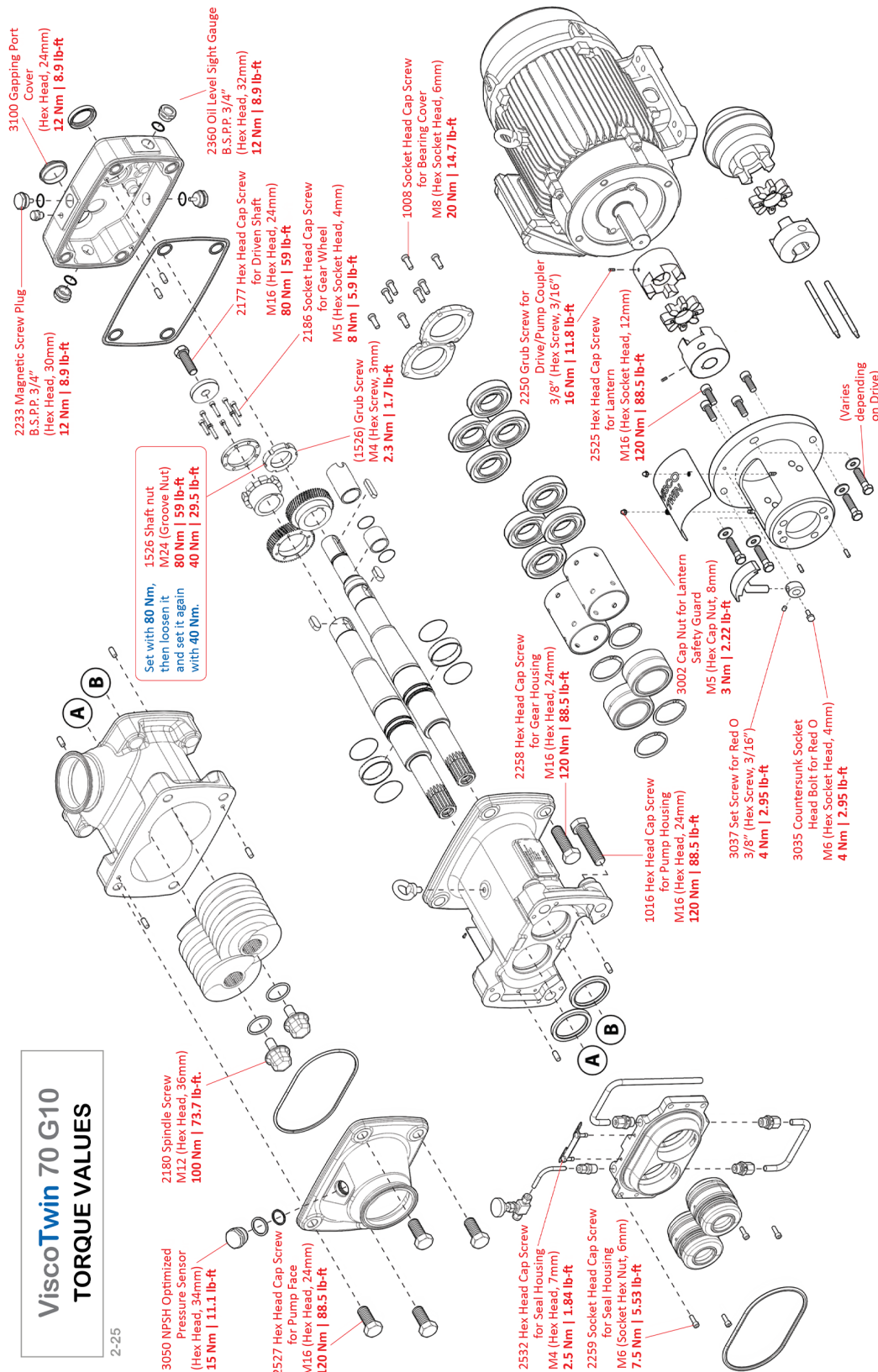



4. SPARE PARTS

4.1 Pump Housing

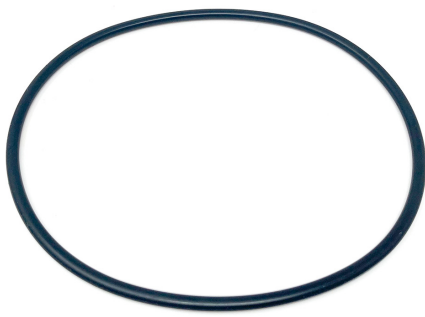
VT70 G10	Spindle Bolt	POS. 2180
PART #	19071	
CUSTOMER REFERENCE #		
MATERIAL	2205	
SPECS	Hex Style	
NOTES	--	

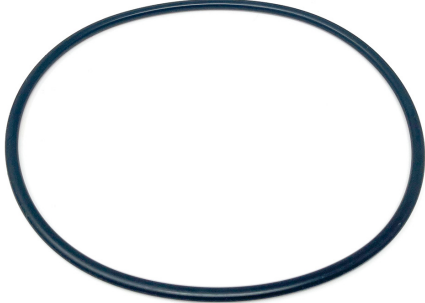
VT70 G10	O-Ring for Pump Face	POS. 2192
PART #	12508	
MPCUSTOMER REFERENCE #		
MATERIAL	FKM	
SPECS	123 x 4mm	
NOTES	--	

VT70 G10	O-Ring for Pump Face	POS. 2192
PART #	12514	
CUSTOMER REFERENCE #		
MATERIAL	EPDM	
SPECS	123 x 4mm	
NOTES	--	

VT70 G10	O-Ring for Spindle Bolt	POS. 2194
PART #	12500	
CUSTOMER REFERENCE #		
MATERIAL	FKM	
SPECS	38 x 3mm	
NOTES	--	

VT70 G10	O-Ring for Spindle Bolt	POS. 2194
PART #	12501	
CUSTOMER REFERENCE #		
MATERIAL	EPDM	
SPECS	38 x 3mm	
NOTES	--	

VT70 G10	Dowel Pin for Pump Face & Housing	POS. 2195, 2196
PART #	12616	
CUSTOMER REFERENCE #		
MATERIAL	303	
SPECS	DIN7 - 8 h 8 x 20mm undersize	
NOTES	--	

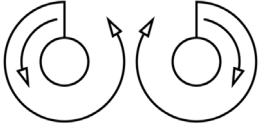
VT70 G10	Spindle Pair VT70.22	POS. 2202
PART #	22207	
CUSTOMER REFERENCE #		
MATERIAL	316L	
SPECS	22mm, hardened	
NOTES		

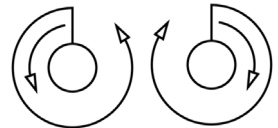
VT70 G10	Spindle Pair VT70.29	POS. 2202
PART #	22705	
CUSTOMER REFERENCE #		
MATERIAL	316L	
SPECS	29mm, hardened	
NOTES		

VT70 G10	Spindle Pair VT70.43	POS. 2202
PART #	22707	
CUSTOMER REFERENCE #		
MATERIAL	316L	
SPECS	43mm, hardened	
NOTES		

VT70 G10	Hex Head Cap Screw for Pump Face	POS. 2527
PART #	23779	
CUSTOMER REFERENCE #		
MATERIAL	A2-70	
SPECS	ISO4017 - M16 x 30mm	
NOTES	--	

VT70 G10	Pump Face OD2-1/2"	POS. 2528
PART #	23642	
CUSTOMER REFERENCE #		
MATERIAL	Fine Cast 1.4409	
SPECS	PF:OD2-1/2", Tri-Clamp	
NOTES	--	

VT70 G10	Pump Face OD3"	POS. 2528
PART #	23641	
CUSTOMER REFERENCE #		
MATERIAL	Fine Cast 1.4409	
SPECS	PF:OD3", Tri-Clamp	
NOTES	--	

VT70 G10	Pump Housing OD2"	POS. 2530
PART #	23643	
CUSTOMER REFERENCE #		
MATERIAL	Fine Cast 1.4409	
SPECS	PH:OD2", Tri-Clamp	
NOTES	--	

VT70 G10	Pump Housing OD2-1/2"	POS. 2530
PART #	23640	
CUSTOMER REFERENCE #		
MATERIAL	Fine Cast 1.4409	
SPECS	PH:OD2-1/2", Tri-Clamp	
NOTES	--	

VT70 G10	Aseptoflex Plug for Sensor Port	POS. 3050
PART #	22252	
CUSTOMER REFERENCE #		
MATERIAL	316L	
SPECS	--	
NOTES	--	

VT70 G10	Gasket for Aseptoflex Plug (green)	POS. 3050 a
PART #	22948	
CUSTOMER REFERENCE #		
MATERIAL	FKM	
SPECS	ID: 29.7mm x OD: 35.7mm	
NOTES	--	

VT70 G10	O-Ring for Aseptoflex Plug	POS. 3050 b
PART #	22253	
CUSTOMER REFERENCE #		
MATERIAL	FKM	
SPECS	O-ring: 24 x 2mm (FKM), in contact with the medium	
NOTES	--	

4.2 Seal Housing

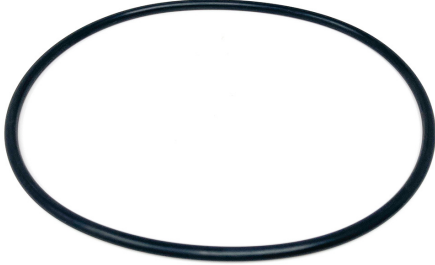
VT70 G10	O-Ring Seal Housing	POS. 1088
PART #	12499	
CUSTOMER REFERENCE #		
MATERIAL	FKM	
SPECS	120 x 4mm	
NOTES	--	

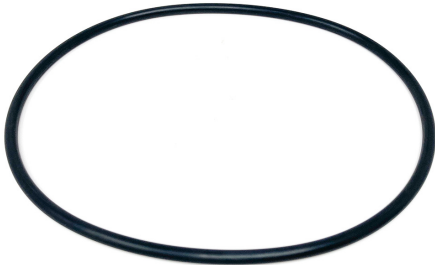
VT70 G10	O-Ring Seal Housing	POS. 1088
PART #	12502	
CUSTOMER REFERENCE #		
MATERIAL	EPDM	
SPECS	120 x 4mm	
NOTES	--	

VT70 G10	Elastomer Kit DAMS	POS. 2535 EK
PART #	23828	
CUSTOMER REFERENCE #		
MATERIAL	E/FKM	
SPECS	HUHNSEAL, SD:36mm	
NOTES	--	

VT70 G10	Mechanical Seal DAMS	POS. 2535
PART #	23675	
CUSTOMER REFERENCE #		
MATERIAL	316Ti/SiC, FKM	
SPECS	HUHNSEAL, SD: 36mm	
NOTES	--	

VT70 G10	Mechanical Seal DAMS	POS. 2535
PART #	23556	
CUSTOMER REFERENCE #		
MATERIAL	316Ti/TuCKE, FKM	
SPECS	HUHNSEAL, SD: 36mm	
NOTES	--	

VT70 G10	Male Connector Straight G3/8 - T1/4	POS. 1863
PART #	21690	
CUSTOMER REFERENCE #		
MATERIAL	316	
SPECS	G-3/8" x 1/4" Tubing	
NOTES	--	

VT70 G10	Male Connector Straight G3/8 - T3/8	POS. 1864
PART #	21689	
CUSTOMER REFERENCE #		
MATERIAL	316	
SPECS	G-3/8" x 3/8" Tubing	
NOTES	--	

VT70 G10	Seal Housing	POS. 2188
PART #	23019	
CUSTOMER REFERENCE #		
MATERIAL	316L	
SPECS	--	
NOTES	--	

VT70 G10	Hex Socket Screw for Seal Housing	POS. 2259
PART #	19366	
CUSTOMER REFERENCE #		
MATERIAL	A2-70	
SPECS	DIN912 - M6 x 20mm	
NOTES	--	

VT70 G10	Safety Guard	POS. 2546
PART #	23612	
CUSTOMER REFERENCE #		
MATERIAL	SS	
SPECS	--	
NOTES	--	

4.3 Bearing Housing

VT70 G10	Key for Coupling	POS. 1183
PART #	12617	
CUSTOMER REFERENCE #		
MATERIAL	304	
SPECS	DIN6885 - A 6 x 6 x 25mm	
NOTES	--	

VT70 G10	Shaft Sealing Ring Bearing Housing	POS. 2322
PART #	22709	
CUSTOMER REFERENCE #		
MATERIAL	FKM	
SPECS	DIN3760 - AS - 55 x 70 x 8mm	
NOTES	--	

VT70 G10	Dowel Pin for Seal Housing	POS. 2536
PART #	21903	
CUSTOMER REFERENCE #		
MATERIAL	303	
SPECS	DIN7 - 8 h 8 x 24mm, undersize	
NOTES	--	

VT70 G10	Drive Shaft	POS. 1000
PART #	23599	
CUSTOMER REFERENCE #		
MATERIAL	316	
SPECS	--	
NOTES	--	

VT70 G10	Shaft Protection Sleeve Gear Housing	POS. 2675
PART #	24929	
CUSTOMER REFERENCE #		
MATERIAL	SS	
SPECS	Hard Inox S treated	
NOTES	--	

VT70 G10	Hex Head Cap Screw for Pump Housing	POS. 1016
PART #	19367	
CUSTOMER REFERENCE #		
MATERIAL	A2-70	
SPECS	ISO4017 - M16 - 2.0 x 55mm, Wrench Size 24mm	
NOTES		

VT70 G10	Hex Head Cap Screw for Gear Housing	POS. 2258
PART #	24889	
CUSTOMER REFERENCE #		
MATERIAL	A2-70	
SPECS	ISO4017 - M16 - 2.0 x 40mm, Wrench Size 24mm	
NOTES		

VT70 G10	O-Ring for Shaft Protection Sleeve Gear Housing	POS. 2676
PART #	23691	
CUSTOMER REFERENCE #		
MATERIAL	FKM	
SPECS	DIN3771 - 25,12 x 1,78mm	
NOTES	--	

VT70 G10	Shaft Protection Sleeve Bearing Housing	POS. 2677
PART #	23601	
CUSTOMER REFERENCE #		
MATERIAL	SS	
SPECS	Hard Inox S treated	
NOTES	--	

VT70 G10	O-Ring for Shaft Protection Sleeve Bearing Housing	POS. 2678
PART #	23692	
CUSTOMER REFERENCE #		
MATERIAL	FKM	
SPECS	--	
NOTES	--	

VT70 G10	Driven Shaft	POS. 2171
PART #	23600	
CUSTOMER REFERENCE #		
MATERIAL	316	
SPECS	--	
NOTES	--	

VT70 G10	Bearing Housing	POS. 1001
PART #	23637	
CUSTOMER REFERENCE #		
MATERIAL	Fine Cast 1.4308	
SPECS	--	
NOTES	--	

VT70 G10	Eyebolt	POS. 1001 a
PART #	23579	
CUSTOMER REFERENCE #		
MATERIAL	304	
SPECS	DIN580 - M10mm	
NOTES	--	

VT70 G10	Needle Roller Bearing	POS. 1003
PART #	23504	
CUSTOMER REFERENCE #		
MATERIAL	--	
SPECS	--	
NOTES	--	

VT70 G10	Lock Snap Ring	POS. 1009 a, b
PART #	19317	
CUSTOMER REFERENCE #		
MATERIAL	STO	
SPECS	--	
NOTES	--	

VT70 G10	Spacer Sleeve for Bearings	POS. 1529
PART #	23609	
CUSTOMER REFERENCE #		
MATERIAL	--	
SPECS	--	
NOTES	--	

VT70 G10	Angular Ball Bearing	POS. 2181
PART #	23569	
CUSTOMER REFERENCE #		
MATERIAL	--	
SPECS	--	
NOTES	--	

VT70 G10	Key for Gear Wheel	POS. 2179
PART #	24870	
CUSTOMER REFERENCE #		
MATERIAL	SS	
SPECS	8 x 7 x 25mm, with 3mm screw hole	
NOTES	--	

VT70 G10	Venting Valve	POS. 2232
PART #	23563	
CUSTOMER REFERENCE #		
MATERIAL	304	
SPECS	M12 - 1,5mm	
NOTES	--	

4.4 Gear Housing

VT70 G10	Shaft Sealing Ring Gear Housing	POS. 1010
PART #	24912	
CUSTOMER REFERENCE #		
MATERIAL	FKM	
SPECS	DIN3760 - AS- 28 x 40 x 7mm	
NOTES	--	

VT70 G10	Magnetic Screw Plug	POS. 2233
PART #	21767	
CUSTOMER REFERENCE #		
MATERIAL	Aluminium	
SPECS	3/4"	
NOTES	--	

VT70 G10	Gasket for Magnetic Screw Plug	POS. 2233 a
PART #	23114	
CUSTOMER REFERENCE #		
MATERIAL	FKM	
SPECS	Gasket for Magnetic Screw Plug	
NOTES	In set of 5 only	

VT70 G10	Oil Level Sight Gauge	POS. 2360
PART #	21766	
CUSTOMER REFERENCE #		
MATERIAL	--	
SPECS	G3/4"	
NOTES	--	

VT70 G10	Gasket for Oil Level Sight Gauge	POS. 2360 a
PART #	23665	
CUSTOMER REFERENCE #		
MATERIAL	FKM	
SPECS	Gasket for Oil Level Sight Gauge	
NOTES	In set of 5 only	

VT70 G10	O-Ring Large for Gear Housing	POS. 2513
PART #	22622	
CUSTOMER REFERENCE #		
MATERIAL	FKM	
SPECS	DIN3771 - 195 x 4mm	
NOTES	--	

VT70 G10	O-Ring Small for Gear Housing	POS. 2514
PART #	22623	
CUSTOMER REFERENCE #		
MATERIAL	FKM	
SPECS	DIN3771 - 18,5 x 2mm	
NOTES	--	

VT70 G10	Gear Oil Bearing Housing VT	POS. 2170
PART #	21871	
CUSTOMER REFERENCE #		
MATERIAL	--	
SPECS	1 L, foodgrade	
NOTES	--	

VT70 G10	Oil Sample Test Kit	POS. 2173
PART #	23580	
CUSTOMER REFERENCE #		
MATERIAL	--	
SPECS	--	
NOTES	--	

VT70 G10	Hex Socket Screw for Bearing Cover	POS. 1008
PART #	19341	
CUSTOMER REFERENCE #		
MATERIAL	Steel 10.9	
SPECS	DIN6912 - M8 x 25mm, B=22mm, Low profile socket head	
NOTES	--	

VT70 G10	Bearing Cover	POS. 1227
PART #	19097	
CUSTOMER REFERENCE #		
MATERIAL	C45	
SPECS	--	
NOTES	--	

VT70 G10	Gear Wheel Nut for Drive Shaft	POS. 1526
PART #	24919	
CUSTOMER REFERENCE #		
MATERIAL	SS	
SPECS	--	
NOTES	--	

VT70 G10	Gear Housing Right	POS. 2172
PART #	23639	
CUSTOMER REFERENCE #		
MATERIAL	Fine Cast 1.4308	
SPECS	Right	
NOTES	--	

VT70 G10	Gear Housing Left	POS. 2172
PART #	23638	
CUSTOMER REFERENCE #		
MATERIAL	Fine Cast 1.4308	
SPECS	Left	
NOTES	--	

VT70 G10	Gapping Port Plug	POS. 3100
PART #	23557	
CUSTOMER REFERENCE #		
MATERIAL	304	
SPECS	40mm	
NOTES	--	

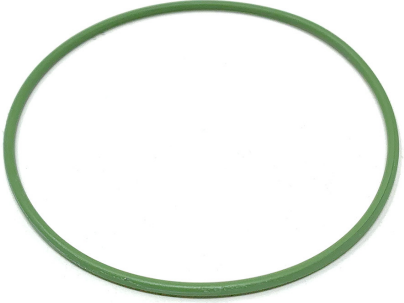
VT70 G10	O-Ring for Gapping Port Plug	POS. 3100 a
PART #	23669	
CUSTOMER REFERENCE #		
MATERIAL	FKM	
SPECS	--	
NOTES	--	

VT70 G10	Gear Wheel Collar Driven Shaft	POS. 2176
PART #	23024	
CUSTOMER REFERENCE #		
MATERIAL	--	
SPECS	--	
NOTES	--	

VT70 G10	Hex Bolt for Driven Shaft	POS. 2177
PART #	22336	
CUSTOMER REFERENCE #		
MATERIAL	Steel 10.9	
SPECS	ISO4017 - M10 x 45mm	
NOTES	--	

VT70 G10	Press Ring Gear Wheel Driven Shaft	POS. 2178
PART #	19334	
CUSTOMER REFERENCE #		
MATERIAL	--	
SPECS	--	
NOTES	--	

VT70 G10	Gear Wheel Drive Shaft	POS. 2183
PART #	22341	
CUSTOMER REFERENCE #		
MATERIAL	AISI 5115, hardened	
SPECS	Z:41teeth, B:31mm, Module 1,5	
NOTES	--	

VT70 G10	Gear Wheel Driven Shaft	POS. 2184
PART #	22342	
CUSTOMER REFERENCE #		
MATERIAL	AISI 5115, hardened	
SPECS	41 Teeth, B:16mm, Module 1,5	
NOTES	--	

VT70 G10	Hex Socket Screw for Gear Synchronization Lock Ring	POS. 2186
PART #	22334	
CUSTOMER REFERENCE #		
MATERIAL	Steel 12.9	
SPECS	DIN912 - M5 x 20mm	
NOTES	--	

VT70 G10	Dowel Pin for Gear Housing	POS. 2256
PART #	18764	
CUSTOMER REFERENCE #		
MATERIAL	303	
SPECS	DIN7 - 8m6 x 20mm, undersize	
NOTES	--	

VT70 G10	Gear Synchronization Lock Ring	POS. 2515
PART #	23025	
CUSTOMER REFERENCE #		
MATERIAL	CS	
SPECS	--	
NOTES	--	